



GREAT YARMOUTH
BOROUGH COUNCIL

Licensing Sub-Committee

Date: Friday, 28 July 2023

Time: 10:00

Venue: Council Chamber

Address: Town Hall, Hall Plain, Great Yarmouth, NR30 2QF

AGENDA

Open to Public and Press

1 **APOLOGIES FOR ABSENCE**

To receive any apologies for absence.

2 **DECLARATIONS OF INTEREST**

You have a Disclosable Pecuniary Interest in a matter to be discussed if it relates to something on your Register of Interests form. You must declare the interest and leave the room while the matter is dealt with.

You have a Personal Interest in a matter to be discussed if it affects

- your well being or financial position
- that of your family or close friends
- that of a club or society in which you have a management role
- that of another public body of which you are a member to a greater extent than others in your ward.

You must declare a personal interest but can speak and vote on the matter.

Whenever you declare an interest you must say why the interest arises, so that it can be included in the minutes.

3 APPLICATION FOR A NEW PREMISES LICENCE FLORIDA 3 - 74
CLUB, BACK MARKET LANE, HEMSBY, GREAT YARMOUTH,
NR29 4HW

Report attached.

4 ANY OTHER BUSINESS

To consider any other business as may be determined by the Chairman of the meeting as being of sufficient urgency to warrant consideration.

5 EXCLUSION OF PUBLIC

In the event of the Committee wishing to exclude the public from the meeting, the following resolution will be moved:-

"That under Section 100(A)(4) of the Local Government Act 1972, the public be excluded from the meeting for the following item of business on the grounds that it involved the likely disclosure of exempt information as defined in paragraph 1 of Part I of Schedule 12(A) of the said Act."

URN:

Subject: Application for a new premises licence : Florida Club, Back Market Lane, Hemsby, Great Yarmouth NR29 4HW

Report to: Licensing Sub-Committee – 28 July 2023

Report by: Licensing Officer

SUBJECT MATTER AND DECISION REQUIRED

The Licensing Sub-Committee is asked to consider the application for a new premises licence in relation to Florida Club, Back Market Lane, Hemsby, Great Yarmouth NR29 4HW

Recommendations:

It is recommended that the Sub-Committee determines the application for a new premises licence in accordance with one of the options set out in paragraph 4 below.

1. Application for a new premises licence

- 1.1 Members are asked to consider an application made by The Florida Club Hemsby Ltd for a new premises licence in relation to Florida Club, Back Market Lane, Hemsby, Great Yarmouth.
- 1.2 The premise is described as a holiday park club house, situated on the Florida holiday site. The premise has two bars and two main rooms, a dressing room for acts and a stage in both rooms plus use of an outdoor area.
- 1.3 Lisa Henry will be the designated premises supervisor for the premise.
- 1.4 The applicant has applied for the following licensable activities and timings: -
 - Supply of alcohol (on and off the premises): 11:00 to 02:00 (Mon – Sat), 11:00 to 00:00 (Sun)
 - Films: 12:00 to 23:00 each day

Live music (inside & out): 11:00 to 23:00 (Sun – Thur), 11:00 to 00:00 (Fri & Sat). Non standard timing: Christmas Eve – 1am close, New Years Eve – 2am close)

Recorded music (inside): 08:00 to 02:00 each day

Recorded music (outside): 10:00 to 22:00 each day

Performance of dance (inside & out): 11:00 to 23:00 (Sun – Thur), 11:00 to 00:00 (Fri & Sat)

Anything similar to live music, recorded music or dance: 11:00 to 23:00 (Sun – Thur), 11:00 to 00:00 (Fri & Sat)

Late night refreshment: 23:00 to 02:00 each day

2. Background information

- 2.1 The application was sent to the Responsible Authorities, advertised by notice at the premise and in a newspaper and detailed on the Council's website.
- 2.2 Upon expiry of the 28 day representation period, 10 valid representations objecting to the application were received and 21 representations in support of the application were received.
- 2.3 The Environmental Health Team also initially submitted a representation objecting to the application. This objection has subsequently been withdrawn due to the applicant agreeing to a number of conditions to be added to the operating schedule.

3. Additional papers

- 3.1 Application for a new premises licence
- 3.2 Copies of the representations objecting to the application
- 3.3 Copies of the representations in support of the application
- 3.4 List of agreed conditions proposed by Environmental Health and representation.
- 3.5 Two plans of the area. One plan showing the Florida Club site outlined in red and one plan showing the clubhouse outlined in red.

4. Options for Members

- 4.1 Grant the application subject to the conditions identified in the operating schedule and modified to such an extent as the authority considers appropriate for the promotion of the licensing objectives.
- 4.2 To exclude from the scope of the licence any of the licensable activities to which the application relates.

4.3 Reject the application.

Areas of consideration: e.g. does this report raise any of the following issues and if so how have these been considered/mitigated against?

Area for consideration	Comment
Monitoring Officer Consultation:	
Section 151 Officer Consultation:	
Existing Council Policies:	
Financial Implications (including VAT and tax):	None
Legal Implications (including human rights):	Yes - Nplaw consulted
Risk Implications:	
Equality Issues/EQIA assessment:	
Crime & Disorder:	
Every Child Matters:	

Application for a premises licence to be granted under the Licensing Act 2003

PLEASE READ THE FOLLOWING INSTRUCTIONS FIRST

Before completing this form please read the guidance notes at the end of the form. If you are completing this form by hand please write legibly in block capitals. In all cases ensure that your answers are inside the boxes and written in black ink. Use additional sheets if necessary.

You may wish to keep a copy of the completed form for your records.

I/We THE FLORIDA CLUB HEMSBY LTD
(Insert name(s) of applicant)

apply for a premises licence under section 17 of the Licensing Act 2003 for the premises described in Part 1 below (the premises) and I/we are making this application to you as the relevant licensing authority in accordance with section 12 of the Licensing Act 2003

Part 1 - Premises details

Postal address of premises or, if none, ordnance survey map reference or description			
FLORIDA CLUB BACK MARKET LANE HEMSBY GREAT YARMOUTH			
Post town	GREAT YARMOUTH	Postcode	NR29 4HW
Telephone number at premises (if any)			
Non-domestic rateable value of premises		£ 22,000	

Part 2 - Applicant details

Please state whether you are applying for a premises licence as Please tick as appropriate

- | | |
|--|---|
| a) an individual or individuals * | <input type="checkbox"/> please complete section (A) |
| b) a person other than an individual * | |
| i as a limited company/limited liability partnership | <input checked="" type="checkbox"/> please complete section (B) |
| ii as a partnership (other than limited liability) | <input type="checkbox"/> please complete section (B) |
| iii as an unincorporated association or | <input type="checkbox"/> please complete section (B) |
| iv other (for example a statutory corporation) | <input type="checkbox"/> please complete section (B) |
| c) a recognised club | <input type="checkbox"/> please complete section (B) |
| d) a charity | <input type="checkbox"/> please complete section (B) |

- e) the proprietor of an educational establishment ☐ please complete section (B)
- f) a health service body ☐ please complete section (B)
- g) a person who is registered under Part 2 of the Care Standards Act 2000 (c14) in respect of an independent hospital in Wales ☐ please complete section (B)
- ga) a person who is registered under Chapter 2 of Part 1 of the Health and Social Care Act 2008 (within the meaning of that Part) in an independent hospital in England ☐ please complete section (B)
- h) the chief officer of police of a police force in England and Wales ☐ please complete section (B)

* If you are applying as a person described in (a) or (b) please confirm (by ticking yes to one box below):

I am carrying on or proposing to carry on a business which involves the use of the premises for licensable activities; or ☒

I am making the application pursuant to a

statutory function or ☐

a function discharged by virtue of Her Majesty's prerogative ☐

(A) INDIVIDUAL APPLICANTS (fill in as applicable)

Mr <input type="checkbox"/>	Mrs <input type="checkbox"/>	Miss <input type="checkbox"/>	Ms <input type="checkbox"/>	Other Title (for example, Rev)	
Surname			First names		
Date of birth		I am 18 years old or over <input type="checkbox"/> Please tick yes			
Nationality					
Current residential address if different from premises address					
Post town				Postcode	
Daytime contact telephone number					
E-mail address (optional)					
Where applicable (if demonstrating a right to work via the Home Office online right to work checking service), the 9-digit 'share code' provided to the applicant by that service (please see note 15 for information)					

SECOND INDIVIDUAL APPLICANT (if applicable)

Mr <input type="checkbox"/>	Mrs <input type="checkbox"/>	Miss <input type="checkbox"/>	Ms <input type="checkbox"/>	Other Title (for example, Rev)	
Surname			First names		
Date of birth			I am 18 years old or over <input type="checkbox"/> Please tick yes		
Nationality					
Where applicable (if demonstrating a right to work via the Home Office online right to work checking service), the 9-digit 'share code' provided to the applicant by that service: (please see note 15 for information)					
Current residential address if different from premises address					
Post town				Postcode	
Daytime contact telephone number					
E-mail address (optional)					

(B) OTHER APPLICANTS

Please provide name and registered address of applicant in full. Where appropriate please give any registered number. In the case of a partnership or other joint venture (other than a body corporate), please give the name and address of each party concerned.

Name	THE FLORIDA CLUB HENSBY
Address	19 BEACH ROAD, HENSBY, GREAT YARMOUTH NORFOLK. NR29 4HJ
Registered number (where applicable)	14741168
Description of applicant (for example, partnership, company, unincorporated association etc.)	Limited Company

Telephone number (if any)
E-mail address (optional) <u>floridacub@yahoo.co.uk</u>

Part 3 Operating Schedule

When do you want the premises licence to start?

DD	MM	YYYY
08	06	2023

If you wish the licence to be valid only for a limited period, when do you want it to end?

DD	MM	YYYY

Please give a general description of the premises (please read guidance note 1)

Holiday Park Club House, situated on Florida Holiday site. The Club House has 2 bars & 2 main rooms, a dressing room for Acts, a stage in Bar Room, a room for Arcades, Office & Kitchen & Cellar. We also have use of the outdoor Gravel area and grassed area. The grassed area is attached too the front Bar and gravel area is attached to Back Bar. 2 BARS Trading Under The Florida Club Hensby - Bar 1 - Bensby's Bar - Florida Club

If 5,000 or more people are expected to attend the premises at any one time, please state the number expected to attend.

--

What licensable activities do you intend to carry on from the premises?

(please see sections 1 and 14 and Schedules 1 and 2 to the Licensing Act 2003)

Provision of regulated entertainment (please read guidance note 2)

Please tick all that apply

- | | |
|---|-------------------------------------|
| a) plays (if ticking yes, fill in box A) | <input type="checkbox"/> |
| b) films (if ticking yes, fill in box B) | <input checked="" type="checkbox"/> |
| c) indoor sporting events (if ticking yes, fill in box C) | <input type="checkbox"/> |
| d) boxing or wrestling entertainment (if ticking yes, fill in box D) | <input type="checkbox"/> |
| e) live music (if ticking yes, fill in box E) | <input checked="" type="checkbox"/> |
| f) recorded music (if ticking yes, fill in box F) | <input checked="" type="checkbox"/> |
| g) performances of dance (if ticking yes, fill in box G) | <input checked="" type="checkbox"/> |
| h) anything of a similar description to that falling within (e), (f) or (g) (if ticking yes, fill in box H) | <input checked="" type="checkbox"/> |

Provision of late night refreshment (if ticking yes, fill in box I)



Supply of alcohol (if ticking yes, fill in box J)



In all cases complete boxes K, L and M

A

Plays Standard days and timings (please read guidance note 7)			Will the performance of a play take place indoors or outdoors or both – please tick (please read guidance note 3)	Indoors	<input type="checkbox"/>
				Outdoors	<input type="checkbox"/>
Day	Start	Finish	Both	<input type="checkbox"/>	
Mon					
Tue			Please give further details here (please read guidance note 4)		
Wed			State any seasonal variations for performing plays (please read guidance note 5)		
Thur					
Fri			Non standard things. Where you intend to use the premises for the performance of plays at different times to those listed in the column on the left, please list (please read guidance note 6)		
Sat					
Sun					

B

Films Standard days and timings (please read guidance note 7)			<u>Will the exhibition of films take place indoors or outdoors or both – please tick</u> (please read guidance note 3)	Indoors <input checked="" type="checkbox"/>
Day	Start	Finish		Outdoors <input type="checkbox"/>
Mon	12:00	23:00	<u>Please give further details here</u> (please read guidance note 4) To play films for Entertainment	Both <input type="checkbox"/>
Tue	12:00	23:00		
Wed	12:00	23:00	<u>State any seasonal variations for the exhibition of films</u> (please read guidance note 5)	
Thur	12:00	23:00		
Fri	12:00	23:00	<u>Non standard timings. Where you intend to use the premises for the exhibition of films at different times to those listed in the column on the left, please list</u> (please read guidance note 6)	
Sat	12:00	23:00		
Sun	12:00	23:00		

C

Indoor sporting events Standard days and timings (please read guidance note 7)			<u>Please give further details</u> (please read guidance note 4)
Day	Start	Finish	
Mon			
Tue			<u>State any seasonal variations for indoor sporting events</u> (please read guidance note 5)
Wed			
Thur			<u>Non standard timings. Where you intend to use the premises for indoor sporting events at different times to those listed in the column on the left, please list</u> (please read guidance note 6)
Fri			
Sat			
Sun			

D

Boxing or wrestling entertainments Standard days and timings (please read guidance note 7)			<u>Will the boxing or wrestling entertainment take place indoors or outdoors or both – please tick</u> (please read guidance note 3)		Indoors	<input type="checkbox"/>
					Outdoors	<input type="checkbox"/>
					Both	<input type="checkbox"/>
Day	Start	Finish	<u>Please give further details here:</u> (please read guidance note 4)			
Mon						
Tue						
Wed			<u>State any seasonal variations for boxing or wrestling entertainment</u> (please read guidance note 5)			
Thur						
Fri						
Sat			<u>Non standard timings. Where you intend to use the premises for boxing or wrestling entertainment at different times to those listed in the column on the left, please list</u> (please read guidance note 6)			
Sun						

E

Live music Standard days and timings (please read guidance note 7)			<u>Will the performance of live music take place indoors or outdoors or both – please tick</u> (please read guidance note 3)	Indoors	<input type="checkbox"/>
				Outdoors	<input type="checkbox"/>
				Both	<input checked="" type="checkbox"/>
Day	Start	Finish	<u>Please give further details here</u> (please read guidance note 4)		
Mon	11.00	23.00			
Tue	11.00	23.00			
Wed	11.00	23.00	<u>State any seasonal variations for the performance of live music</u> (please read guidance note 5)		
Thur	11.00	23.00			
Fri	11.00	24.00			
Sat	11.00	24.00	<u>Non standard timings. Where you intend to use the premises for the performance of live music at different times to those listed in the column on the left, please list</u> (please read guidance note 6)		
Sun	11.00	23.00			
			Christmas Eve - 1pm 1AM New Years Eve - 2am 2AM		

F

Recorded music Standard days and timings (please read guidance note 7)			<u>Will the playing of recorded music take place indoors or outdoors or both – please tick</u> (please read guidance note 3)	Indoors	<input type="checkbox"/>
				Outdoors	<input type="checkbox"/>
				Both	<input checked="" type="checkbox"/>
Day	Start	Finish			
Mon	08:00	02:00	<u>Please give further details here</u> (please read guidance note 4) To Be Able to play Recorded music Between 8am + 2pm indoors, and 10am to 22:00 outside.		
Tue	08:00	02:00			
Wed	08:00	02:00	<u>State any seasonal variations for the playing of recorded music</u> (please read guidance note 5)		
Thur	08:00	02:00			
Fri	08:00	02:00	<u>Non standard timings. Where you intend to use the premises for the playing of recorded music at different times to those listed in the column on the left, please list</u> (please read guidance note 6)		
Sat	08:00	02:00			
Sun	08:00	02:00			

G

Performances of dance Standard days and timings (please read guidance note 7)			<u>Will the performance of dance take place indoors or outdoors or both – please tick</u> (please read guidance note 3)	Indoors <input type="checkbox"/> Outdoors <input type="checkbox"/> Both <input checked="" type="checkbox"/>
Day	Start	Finish		
Mon	11.00	23.00	<u>Please give further details here</u> (please read guidance note 4)	
Tue	11.00	23.00		
Wed	11.00	23.00	<u>State any seasonal variations for the performance of dance</u> (please read guidance note 5)	
Thur	11.00	23.00		
Fri	11.00	24.00	<u>Non standard timings. Where you intend to use the premises for the performance of dance at different times to those listed in the column on the left, please list</u> (please read guidance note 6)	
Sat	11.00	24.00		
Sun	11.00	23.00		

H

Anything of a similar description to that falling within (e), (f) or (g) Standard days and timings (please read guidance note 7)			Please give a description of the type of entertainment you will be providing Comedy Acts, Bands, Singers, Entertainers Darts, Pool team, BENSLEY'S BINGO		
Day	Start	Finish	<u>Will this entertainment take place indoors or outdoors or both – please tick</u> (please read guidance note 3)		Indoors <input type="checkbox"/> Outdoors <input type="checkbox"/> Both <input checked="" type="checkbox"/>
Mon	11.00	23.00	Please give further details here (please read guidance note 4)		
Tue	11.00	23.00			
Wed	11.00	23.00			
Thur	11.00	23.00	<u>State any seasonal variations for entertainment of a similar description to that falling within (e), (f) or (g)</u> (please read guidance note 5)		
Fri	11.00	24.00			
Sat	11.00	24.00			
Sun	11.00	23.00	<u>Non standard times. Where you intend to use the premises for the entertainment of a similar description to that falling within (e), (f) or (g) at different times to those listed in the column on the left, please list</u> (please read guidance note 6)		

I

Late night refreshment Standard days and timings (please read guidance note 7)			Will the provision of late night refreshment take place indoors or outdoors or both – please tick (please read guidance note 3)	Indoors	<input type="checkbox"/>
				Outdoors	<input type="checkbox"/>
				Both	<input checked="" type="checkbox"/>
Day	Start	Finish	<u>Please give further details here</u> (please read guidance note 4)		
Mon	08:00	02:00			
Tue	08:00	02:00	<u>State any seasonal variations for the provision of late night refreshment</u> (please read guidance note 5)		
Wed	08:00	02:00			
Thur	08:00	02:00	<u>Non standard timings. Where you intend to use the premises for the provision of late night refreshment at different times, to those listed in the column on the left, please list</u> (please read guidance note 6)		
Fri	08:00	02:00			
Sat	08:00	02:00			
Sun	08:00	02:00			

J

Supply of alcohol Standard days and timings (please read guidance note 7)			Will the supply of alcohol be for consumption – please tick (please read guidance note 8)	On the premises	<input type="checkbox"/>
				Off the premises	<input type="checkbox"/>
Day	Start	Finish		Both	<input checked="" type="checkbox"/>
Mon	11:00	02:00		State any seasonal variations for the supply of alcohol (please read guidance note 5)	
Tue	11:00	02:00			
Wed	11:00	02:00			
Thur	11:00	02:00	Non standard timings. Where you intend to use the premises for the supply of alcohol at different times to those listed in the column on the left, please list (please read guidance note 6)		
Fri	11:00	02:00			
Sat	11:00	02:00			
Sun	11:00	24:00			

State the name and details of the individual whom you wish to specify on the licence as designated premises supervisor (Please see declaration about the entitlement to work in the checklist at the end of the form):

Name	LISA HENBY
Date of birth	[REDACTED]
Address	19 Beach Road HENSBY GREAT YARMOUTH NORFOLK
Postcode	NR29 4HT
Personal licence number (if known)	PA2025
Issuing licensing authority (if known)	GREAT YARMOUTH Borough Council

K

Please highlight any adult entertainment or services, activities, other entertainment or matters ancillary to the use of the premises that may give rise to concern in respect of children (please read guidance note 9).

2x fruit Machines
- Adult Comedy Acts
- Bensly's Bungo

L

Hours premises are open to the public Standard days and timings (please read guidance note 7)			State any seasonal variations (please read guidance note 5)
Day	Start	Finish	
Mon	8.00	03.00	<p><u>Non standard timings. Where you intend the premises to be open to the public at different times from those listed in the column on the left, please list</u> (please read guidance note 6)</p>
Tue	8.00	03.00	
Wed	8.00	3.00	
Thur	8.00	3.00	
Fri	8.00	3.00	
Sat	8.00	3.00	
Sun	8.00	3.00	

M

Describe the steps you intend to take to promote the four licensing objectives:

a) General – all four licensing objectives (b, c, d and e) (please read guidance note 10)

- Risk Assessments
- Staff training
- Policies

b) The prevention of crime and disorder

- CCTV ~~not~~ to be installed
- ^{Drugs Policy} Join Police if we have one on our area
- Risk Assessments
- Staff training
- work with the police
- Not serve alcohol to someone who is drunk or appears to be

c) Public safety

- CCTV to be installed
- lighting + External lighting
- Staff training
- Clear access to all areas
- Capacity limits
- operation Emergency lighting

d) The prevention of public nuisance

- outside music to be at a reasonable decible
- outside music to be off by 11pm
- noise reduction policy
- ~~no glass outside~~
- Signs when leaving to keep noise down

e) The protection of children from harm

- Challenge 25 scheme
- no children allowed in premises without suitable adult
- No sale of Alcohol to anyone under the age of 18
- Staff training

Checklist:

Please tick to indicate agreement

- I have made or enclosed payment of the fee. ☐
- I have enclosed the plan of the premises. ☐
- I have sent copies of this application and the plan to responsible authorities and others where applicable. ☐
- I have enclosed the consent form completed by the individual I wish to be designated premises supervisor, if applicable. ☒
- I understand that I must now advertise my application. ☒
- I understand that if I do not comply with the above requirements my application will be rejected. ☒
- [Applicable to all individual applicants, including those in a partnership which is not a limited liability partnership, but not companies or limited liability partnerships] I have included documents demonstrating my entitlement to work in the United Kingdom or my share code issued by the Home Office online right to work checking service (please read note 15). ☐

IT IS AN OFFENCE, UNDER SECTION 158 OF THE LICENSING ACT 2003, TO MAKE A FALSE STATEMENT IN OR IN CONNECTION WITH THIS APPLICATION. THOSE WHO MAKE A FALSE STATEMENT MAY BE LIABLE ON SUMMARY CONVICTION TO A FINE OF ANY AMOUNT.

IT IS AN OFFENCE UNDER SECTION 24B OF THE IMMIGRATION ACT 1971 FOR A PERSON TO WORK WHEN THEY KNOW, OR HAVE REASONABLE CAUSE TO BELIEVE, THAT THEY ARE DISQUALIFIED FROM DOING SO BY REASON OF THEIR IMMIGRATION STATUS. THOSE WHO EMPLOY AN ADULT WITHOUT LEAVE OR WHO IS SUBJECT TO CONDITIONS AS TO EMPLOYMENT WILL BE LIABLE TO A CIVIL PENALTY UNDER SECTION 15 OF THE IMMIGRATION, ASYLUM AND NATIONALITY ACT 2006 AND PURSUANT TO SECTION 21 OF THE SAME ACT, WILL BE COMMITTING AN OFFENCE WHERE THEY DO SO IN THE KNOWLEDGE, OR WITH REASONABLE CAUSE TO BELIEVE, THAT THE EMPLOYEE IS DISQUALIFIED.

Part 4 – Signatures (please read guidance note 11)

Signature of applicant or applicant's solicitor or other duly authorised agent (see guidance note 12). If signing on behalf of the applicant, please state in what capacity.

Declaration	<ul style="list-style-type: none">• [Applicable to individual applicants only, including those in a partnership which is not a limited liability partnership] I understand I am not entitled to be issued with a licence if I do not have the entitlement to live and work in the UK (or if I am subject to a condition preventing me from doing work relating to the carrying on of a licensable activity) and that my licence will become invalid if I cease to be entitled to live and work in the UK (please read guidance note 15).• The DPS named in this application form is entitled to work in the UK (and is not subject to conditions preventing him or her from doing work relating to a licensable activity) and I have seen a copy of his or
--------------------	---

	her proof of entitlement to work, or have conducted an online right to work check using the Home Office online right to work checking service which confirmed their right to work (please see note 15)
Signature	[REDACTED]
Date	20/5/23
Capacity	Licensees

For joint applications, signature of 2nd applicant or 2nd applicant's solicitor or other authorised agent (please read guidance note 13). If signing on behalf of the applicant, please state in what capacity.

Signature	
Date	
Capacity	

Great Yarmouth Borough Council is committed to protecting the rights and privacy of individuals with regard to the processing of personal data.

The information supplied will be processed under Article 6(1)(e) – Public Task

To view the complete Licensing privacy statement please go to www.great-yarmouth.gov.uk/licensing

Contact name (where not previously given) and postal address for correspondence associated with this application (please read guidance note 14)		
LISA HENRY 19 BEACH ROAD HEMSBY		
Post town	GREAT YARMOUTH	Postcode NR29 4HJ
Telephone number (if any)	[REDACTED]	
If you would prefer us to correspond with you by e-mail, your e-mail address (optional)		
FLORIDACUBS@YAHOO.COM		



Great Yarmouth Borough Council Licensing Act 2003

Consent of individual to being specified as premises supervisor

I LISA HENRY
[full name of prospective premises supervisor]

of SYCAMORE, 19 BEACH ROAD
HEMSBY
GREAT YARMOUTH
NR29 4HJ

[home address of prospective premises supervisor]

hereby confirm that I give my consent to be specified as the designated premises supervisor in relation to the application for

Premises Licence
[type of application]

by

LISA HENRY / SCOTT BENSLY / THE FLORIDA CLUB LTD
[name of applicant]

relating to a premises licence

[number of existing licence, if any]

for

THE FLORIDA CLUB
BACK MARKET LANE
HEMSBY
GREAT YARMOUTH
NR29 4HW

[name and address of premises to which the application relates]

and any premises licence to be granted or varied in respect of this application made by

THE FLORIDA CLUB HEMSBY LTD / LISA HENRY, SCOTT BENSLY
[name of applicant]

concerning the supply of alcohol at

THE FLORIDA CLUB, HEMSBY
BACK MARKET LANE
HEMSBY
GREAT YARMOUTH.
NR29 4HW

(name and address of premises to which application relates)

I also confirm that I am entitled to work in the United Kingdom and am applying for, intend to apply for or currently hold a personal licence, details of which I set out below.

Personal licence number

PA 2025

(insert personal licence number, if any)

Personal licence issuing authority

GREAT YARMOUTH BOROUGH Council

(insert name and address and telephone number of personal licence issuing authority, if any)

Signed



Name (please print)

L. HENRY

Date

31/5/23

Great Yarmouth Borough Council is committed to protecting the rights and privacy of individuals with regard to the processing of personal data.

The information supplied will be processed under Article 6(1)(e) – Public Task

To view the complete Licensing privacy statement please go to www.great-yarmouth.gov.uk/licensing

Please return this form to:-

The Licensing Team,
Greyfriars House,
Greyfriars Way,
Great Yarmouth,
NR30 2QE

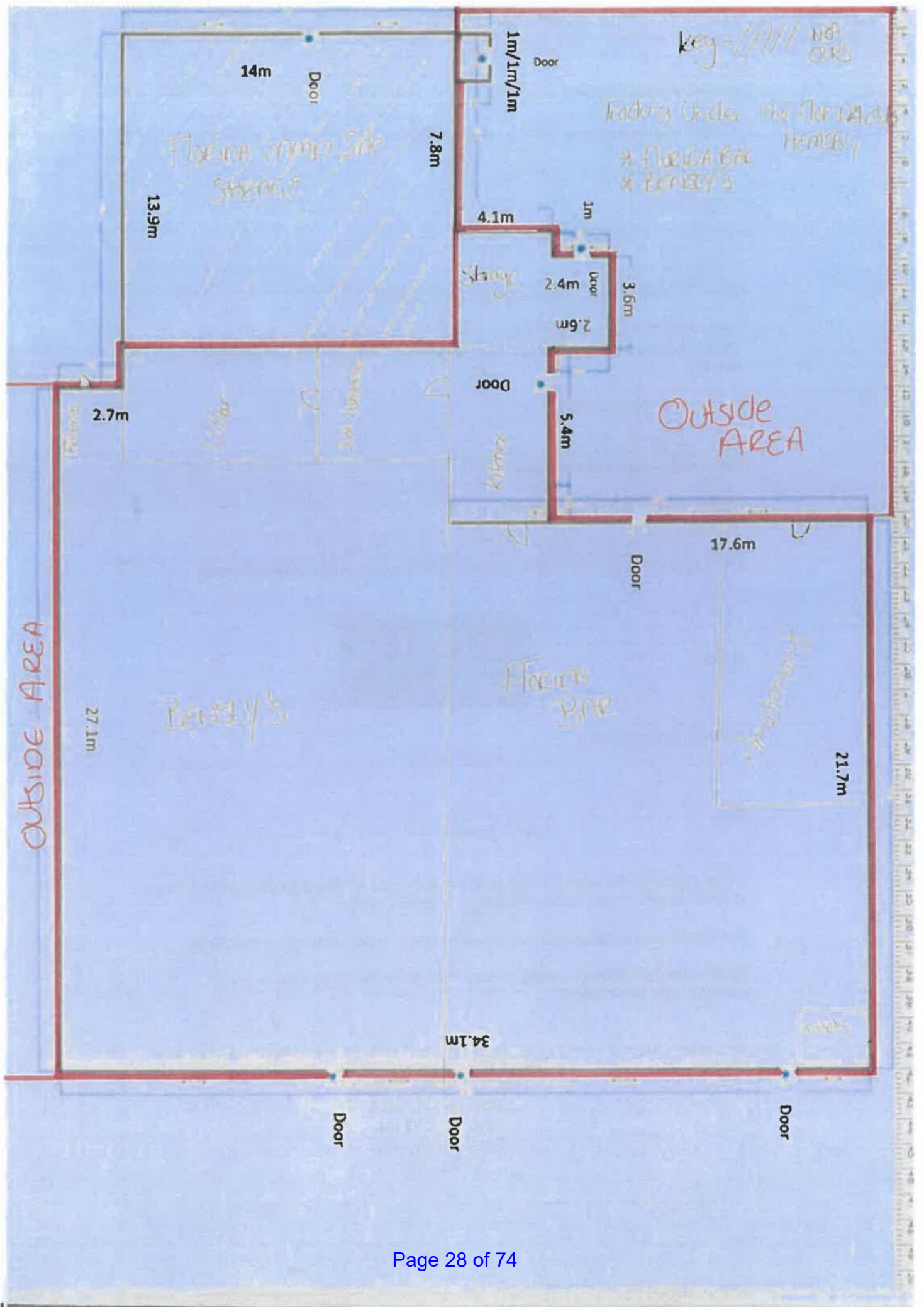

Elaine M. Hignett

From: Jen Cog [REDACTED]
Sent: 15 June 2023 19:13
To: licensing
Subject: The Florida Club Hemsby New Application

Categories: Green category

Dear Sir/Madam

I refer to the above application by The Florida Club at Hemsby and would advise that I object to the

1. Recorded music (inside): 08.00 to 02.00 each day - because although the music is inside it is still the volume of noise. However, I have no objection to it finishing at 23.00 each day.
2. Late night refreshment: 23.00 to 02.00 each day. - Why? I currently have to wait until the enter anyway on the Seadell site. There is no need to stay open serving alcohol until 02.00 as this will on early hours of the morning.
3. Sale of alcohol (on and off the premises): 11.00 to 02.00 (Mon to Sat), 11.00 to 00.00 (Sun) Aga that they can obtain alcohol up until 02.00. Who will control the noise level? who will stop people people from shouting and singing as they walk home. I have no objection to the sale of alcohol finis

Please note that noise travels more at night time. I always hear the entertainment from The Florida until it ends before I can go to bed to sleep. Extended licensing is NOT NEEDED by The Florida Club. whether inside or out, should all end at 23.00 each day as a matter of courtesy and decorum to oth could increase the risk of public crime, public disorder, public nuisance and public safety.

I trust my objection to the above will be noted and I await hearing from you further in due course.

With Kind Regards

Yours faithfully,

Mrs J Cogdell
Chalet No. 80 Seadell Site

Home Address - 41 Leys Road, Pattishall, Northants. NN2 8JY

Elaine M. Hignett

From: Deborah Wood [REDACTED]
Sent: 15 June 2023 17:42
To: licensing
Subject: Licensing application representation

Categories: Green category

Objection to licensing application for Florida Club Ltd, Back Lane, Hemsby.

I would like to object to the application to extend licensing to 02.00 am on the grounds of ;

Hemsby is a holiday destination for families predominantly those with young children. It is not acceptable for sleep disturbance after the usual cut off of 10.30pm.

I feel granting this application would infringe on the enjoyment of holiday makers.

This objection includes The Sale of refreshments until 02.00am, Music until 02.00am and Off Sales until 02.00am.

Granting this application would affect other holiday parks, not just Florida, with people moving between parks to their accommodation, thus the disturbance goes beyond 02.00am.

I own a chalet on Seadell Holidsy Park, immediately adjacent to Florida Club, I feel it would spoil the enjoyment of my holiday home and prevent me from renting to families and elderly people, who wish to enjoy peaceful evenings and I disturbed rest.

Belle Aire clubhouse is already a problem, with loud music and partying outside and their cut off is 11.30.

The Dunes development on the other side of Back Market lane has permission for residential homes, there are residential property's on beach road and Newport Rd.

The clubs hours should not be extended beyond normal residential pub hours and the disturbance to neighbours regulations should apply. In this instance, all surrounding properties residential and holiday have enjoyed a quiet area, I would not have purchased a holiday property next door to a club with a license until 02.00am, in fact I believe Florida Club has been closed for some years.

Regards

Mrs Deborah Wood

Elaine M. Hignett

From: Deborah Wood <[REDACTED]>
Sent: 15 June 2023 18:28
To: licensing
Subject: Re: Automatic reply: Licensing application representation
Categories: Green category

Further to my objection, I would like to add this current sign at Florida Park Club.

This is not a responsible licensee, this is a business with a poor attitude to the legalities of the licensing laws.

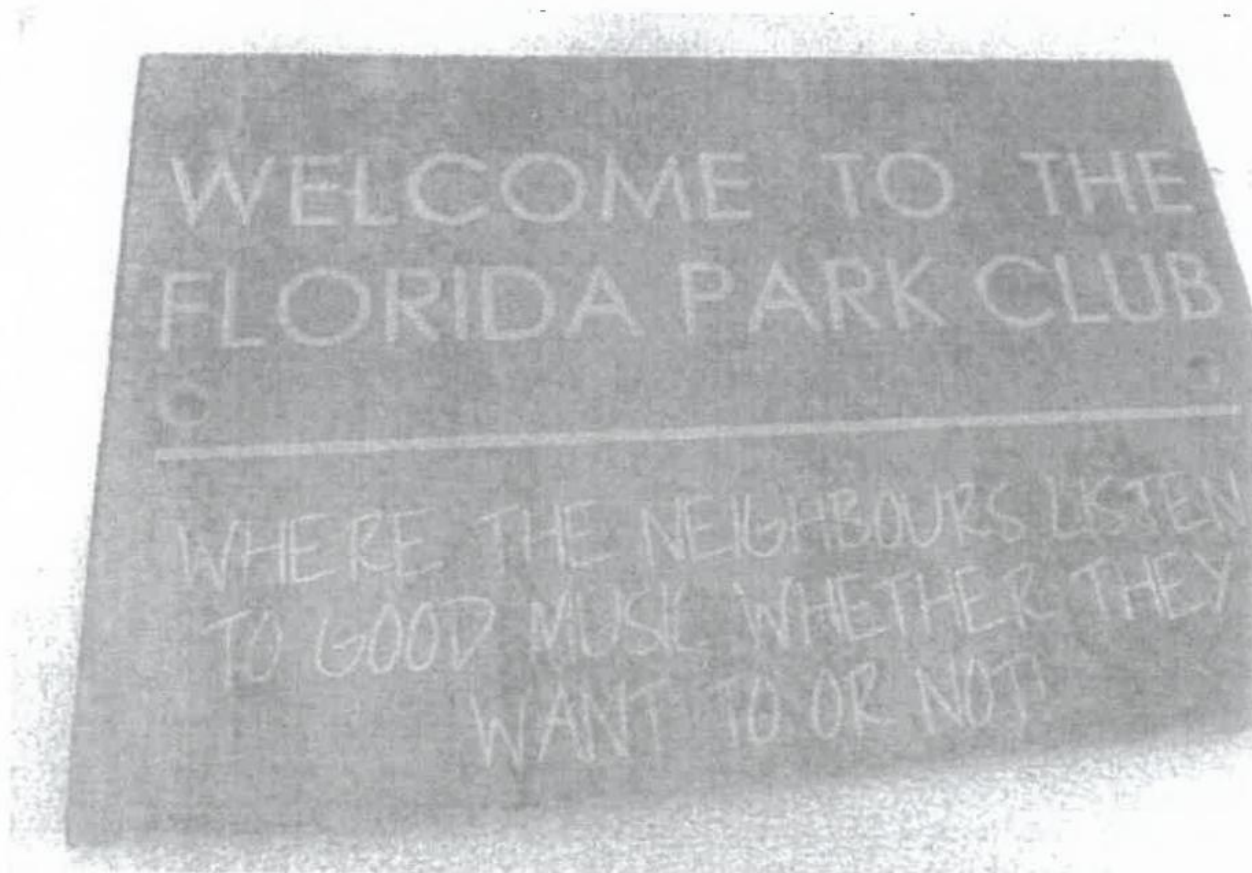

Elaine M. Hignett

From: Deb <[REDACTED]>
Sent: 15 June 2023 22:22
To: licensing
Subject: Objection to licensing application

Categories: Green category

The Florida Club, Hemsby.

I would like to object to the application for a music, refreshment and off sales licence closing at 2am.

I believe a licence for anything later than 11pm would be detrimental to both holidaymakers and residents.

I would like to see transparency in this matter as I believe the applicant has connections to Councillor James Bensley.

D Holmes

Sent from Yahoo Mail for iPhone

Elaine M. Hignett

From: zenaoliver [REDACTED]
Sent: 18 June 2023 10:48
To: licensing
Subject: Representation in respect of a Premises Licence

Please may I submit my objection to the late licence for Florida Park club
My reasons being when the club had a late licence before my holiday chalet customers were unable to sleep with the windows open because of the loud music noise making the hot stuffy nights unbearable

On top of this the drunken ppl cutting through Seadell site we had beer bottles glasses and cans thrown in a trail from the club the noise of children and youths running around screaming and shouting in the early hours when they should be in bed leaving the club

On our site there is a noise clause in our leases saying no noise after 10.30pm

I am not against the club being opened just the very late licence which seems to appeal to the applicants pals

I do hope you do take great consideration to the negative outcomes of this application as I don't see why one business should be allowed to make everybody's holidays miserable and unbearable
It's already hard getting bookings after the press saying the beach will be shut for 20 yrs

Many thanks for your time in considering my objections

Mrs Zena Oliver

14 CORONATION AVENUE

MOIRA

Sent from my Galaxy

SWADLINCOTE

DERBYSHIRE.

Elaine M. Hignett

From: MICHAEL ELY [REDACTED]
Sent: 20 June 2023 12:18
To: licensing
Subject: Premises license application The Florida Club Back Market Lane Hemsby NR29 4HW
Categories: Green category

To licensing@great-yarmouth.gov.uk

20th June 2023

I wish to register my objection to the Application for the premises licence at

The Florida Club

Back Market Lane

Hemsby

Great Yarmouth

NR29 4HW

1. This is a very old building with little sound proofing and any music played within reverberates a considerable distance.

2. The club is epicentre to three holiday sites namely, Florida club, Seadell site and Bermuda site. The holiday visitors and owners of the chalets and houses surrounding the Club House are mainly older people or young families with young children.

My main objection is to the extended hours proposed namely 0200 and midnight and to music outside the premises. Whilst many holiday makers will find the noise intrusive I consider that if the music and sale of alcohol ceased at 23.15 as per the previous arrangement, then this should be quite acceptable as a compromise for all.

Via the social media I have obtained some response from those who support the application, most of whom are local permanent residence. The reaction has been quite appalling, such as remarks:

"can't wait to leave here at 2am drunk and singing".

"like the old times when ***** pinched all those signs"

It seems to me that the late night hours of the application appeal more to the local permanent residence, without little consideration being given to the holiday makers in the adjoining chalets and houses.

I would be most grateful if the Committee would consider these comments when discussing the application.

Thank you,

Michael Ely

4 BRENTWOOD PLACE
BRENTWOOD
CM15 9DN.

From: Ivan Baxendale [REDACTED]
Sent: 25 June 2023 12:47
To: complaints <complaints@great-yarmouth.gov.uk>
Subject:

I would like to object to the application of alcohol licence to Scott bensley of the Florida club Hemsby .my reasons are the noise and because the club is isolated away I feel it cannot be managed responsibly. I feel Scott bensley is not capable of running the above said club.

IVAN BAXENDALE
47 BELLE AIRE, BEACH ROAD , HEMSBY

Elaine M. Hignett

From: Emma Searle [REDACTED]
Sent: 04 July 2023 17:21
To: licensing
Subject: Florida Club License Application

Categories: Green category

Good Afternoon,

I wish to appeal the application made for the extension to the Florida Club License Application on the following grounds.

I feel that having a license until 11:00pm Monday- Saturday is more than sufficient as if the hours are to be extended patrons will have a longer period to consume alcohol to only disturb their neighbours in the surrounding area with anti social behaviour.

With continued cut backs to our police force, I doubt this will be a priority call and will needlessly disrupt many family holidays.

The other issue is that the freeholders of these parks are not always a visual presence when an issue occurs, especially late at night.

At present, I am aware that the building works has ceased on the old Pontins site, however as I was led to believe this was also go to be a residential estate and I believe this noise will carry.

I do hope the points that I have raised are taken into consideration.

Yours Sincerely,

Emma Hart.

Sent from my iPhone

Elaine M. Hignett

From: J Hedger <[REDACTED]>
Sent: 02 July 2023 22:19
To: licencesing@great-yarmouth.gov.uk; licensing
Subject: Late license

I am writing up appose the licence that has been applied for the Florida club back lane hemsby
The applicant has a conflict of interest due to his connections with the council and land owner
There is insufficient parking. Lighting and security
The noise will prevent those owners who use the chalets for rest and relaxation not to stay up all night with noise
This could also increase the already high volume of crime
J hedger
92 Florida estate

1 July 2023

Licensing (Register)
Great Yarmouth Council
Town Hall, Great Yarmouth,
NORFOLK NR30 2QF

Dear Sir

OBJECTION
Licensing Application
FLORIDA CLUB

229, Warren Drive,
Elm Park,
HORNCHURCH, Essex,
RM12 4PL
(01708 458207)

Great Yarmouth Borough Council

- 5 JUL 2023

Customer Services

We are writing to strongly object to the application made by the Florida Club, Back Market Lane, Hensby, Great Yarmouth, NR29 4HW. We understand that an application has been made by the Florida Club for an extension of licensing activities until 02:00am for the sale of alcohol & refreshments and for live/recorded music (& films) both inside and outside the premises.

We own a property on the Bermuda Holiday Park which is immediately adjacent to the Florida Clubhouse. Our chalet is actually on the other side of the boundary fence, facing 2 of our bedrooms, and is very close to the location of the Florida Clubhouse. Bermuda, Florida and the neighbouring Seadell site all cater for holidays for families, some with young families and some elderly residents. A late license for such activities until 02:00am would obviously create much noise, nuisance and disturbance, especially from outside the premises, and would have a detrimental effect on site residents wishing to relax and sleep.

In the past, we have occasionally experienced noise & nuisance from loud music during existing opening hours,

especially when the doors and windows of the Florida clubhouse have been open in hot weather. Such activities until 02:00am would be inconsiderate, detrimental and completely unacceptable to those residents wishing to enjoy a relaxed and peaceful holiday.

We sincerely hope that you will take our comments into account and make the request that this application for a late extension license be refused on the grounds of noise, nuisance and antisocial hours.

Thank you.

Yours truly,

[Redacted] (Mrs)

Mr & Mrs. R. Clements

Elaine M. Hignett

From: [REDACTED] m
Sent: 05 July 2023 14:18
To: licensing
Subject: Licence Application - Florida Holiday Park Hemsby
Categories: Green category

Dear Sirs,

I own the Bermuda Holiday Park at Hemsby and I strongly object to the above Licensing Application. I only found out yesterday the details of the application and as our site backs onto the Florida I cannot understand why I was not notified.

Our site borders the Florida and every Summer that they have been open we have had a problem with the noise generated by them. We get lots of complaints from people staying on our site as they have all the windows open and also both fire doors which are immediately on the other side of our fence.

Hemsby is a family location with Bermuda, Seadell and Belle Air all catering for families with young children and grandparents to enjoy a lovely holiday which is both peaceful and relaxing.

In my opinion granting a 2.00 am licence with outside music and drinking will mainly attract local teenagers (who are probably underage) and teenagers on holiday from other sites. It would be hard to control properly and would encourage them to take their own drinks, resulting in excessive noise, people drinking heavily, smoking and rowdiness.

All the chalets on our site are privately owned for holiday lettings only. If there is loud music and they get a lot of complaints their guests will demand their money back and not return.

I hope my points will all be taken into account when the application is considered.

Thanking You

Regards

Berndt Edmonds

Owner and Landlord of Bermuda Holiday Park

ALCREST, NEWPORT ROAD,
HEMSBY, GREAT YARMOUTH.

Sent from Sky Yahoo Mail for iPhone

Elaine M. Hignett

From: r.hubbard123 [REDACTED]
Sent: 15 June 2023 21:07
To: licensing
Subject: Florida Club Hemsby

Categories: Green category

Hello, I am emailing to give my full support in the application from the proprietor of the florida club.. I feel that the licence should be granted as I feel this club will be of benefit to hemsby, as someone who doesn't live in hemsby but has quite often frequented the florida club when previous landlords were present. It has a huge potential to put hemsby back on the map with regards to entertainment should this licence be granted, and with so many clubs failing at the moment through one thing or another I feel the new proprietor should at least be given the chance to prove what a great little club it can be.

Kind regards
Rob Hubbard

185 NORWICH ROAD
WYMONDHAM
Sent from Samsung Mobile on 02
NORWICH

Elaine M. Hignett

From: Angela Easter <[REDACTED]>
Sent: 16 June 2023 14:15
To: licensing
Subject: Florida club Hemsby

Categories: Green category

Good afternoon

I am writing in response to the planning which has been applied for at the Florida club

This has always been a great asset to the area and as such would be a shame not to have planning granted, it brings in much needed jobs and income to the area and is an attraction to tourists.

Kind regards. A Easter

Sent from Sky Yahoo Mail for iPhone

Elaine M. Hignett

From: Angela Easter [REDACTED]
Sent: 19 June 2023 11:14
To: Elaine M. Hignett
Subject: Re: Florida club Hemsby

Categories: To Do

Hi Elaine
Yes it is sorry for confusing wording.
Angie

Sent from Sky Yahoo Mail for iPhone

On Friday, June 16, 2023, 3:46 pm, Elaine M. Hignett <Elaine.Hignett@great-yarmouth.gov.uk> wrote:

Good afternoon

I am in receipt of your email in relation to the Florida Club. Your email refers to 'planning' being applied for, but the application that the Licensing Authority is currently dealing with relates to a premises licence for alcohol and regulated entertainment.

Can you confirm whether your email is a representation in support of the alcohol premises licence application?

Kind regards

Elaine

Elaine M. Hignett
Licensing Officer
Licensing and Elections
Environmental Services
Great Yarmouth Borough Council

Email: Elaine.Hignett@great-yarmouth.gov.uk
www.great-yarmouth.gov.uk
Telephone: 01493846530

Elaine M. Hignett

From: Ian A <[REDACTED]>
Sent: 19 June 2023 04:44
To: licensing
Subject: Florida Holiday Park Clubhouse

Categories: Green category

Good morning..

I am emailing in support for the granting of the license being applied for by Mr Scott Bensly regarding the opening hours/entertainment hours submitted for the Clubhouse on Florifay Holiday Park in Hemsby. The Florida Clubhouse is on a holiday park with no residential properties within close proximity of it and have no objection to granting the license that other cluhouses/drinking establishments already hold. By granting the license it will bring more revenue into Hemsby and give holiday makers staying onsite the benifit of enjoying nights out onsite without having to walk to other venues within Hemsby and past residential properties late at night..

Many thanks

Mr Ian Armstrong (Hemsby resident)

404 THE GLEBE
HEMSBY
NR29 4JA

Elaine M. Hignett

From: Jude Clark <[REDACTED]>
Sent: 19 June 2023 13:30
To: licensing
Subject: Florida Club Hemsby

Categories: Green category

Please accept this email as a showing of support to allow the Florida Club a license to run. I remember how great the club on site used to be years ago. After visiting recently and seeing no club on site I felt desperately sad. Please give this man and his family a chance to bring life back to this site in the form of a club house. Too many businesses are failing and you should get behind them and help them succeed.

J Clark

Sent from my iPhone

90 DEEP SPINNEY
BIDDENHAM
BEDFORD
MK40 4QN.

Elaine M. Hignett

From: James Taylor [REDACTED]
Sent: 18 June 2023 10:39
To: licensing
Subject: Florida Club, Hemsby Licence

Good morning

I am emailing to you to support this application of late license for the Florida Club Hemsby.

Hemsby needs to be brought back on the map for entertainment and this will help.

Will be a great venue for locals and holiday makers bringing more money into the village as well.

Thank you

James Taylor

5 PYMAN CLOSE
MARTHAM
NR29 4UR

Elaine M. Hignett

From: Jennifer Vye <[REDACTED]>
Sent: 18 June 2023 10:19
To: licensing
Subject: Florida club Hemsby

I'm getting in touch to say think you should be getting this open, as so many people would like to see it open, locals etc, be such a shame if it didn't happen.

Elaine M. Hignett

From: stella sawyer <[REDACTED]>
Sent: 17 June 2023 22:33
To: licensing
Subject: License for Florida club Hemsby

Regarding the license for the Florida club in Hemsby please give the license as it is a holiday resort with very little entertainment for adults as well as good evening entertainment for families other than amusement arcades

What is wrong with people this is a seaside holiday resort that needs entertainment for all ages . Not just the beach which is sadly diminishing 😞 it will mean more people in the holiday seasons to bring in more revenue for businesses as well as the Florida club. Residents knew when they purchased their properties & holiday homes that it's a HOLIDAY RESORT where people go for holidays & fun ! All holidays parks /resorts have late licenses why should hemsby be any different. Give the license to him give it a try , those who are against you may like to pop along for some entertainment themselves lyou never know

Please reconsider I visit regular & there is not much evening entertainment like to see performers like singers or bands etc for dancing or good sing along. So been starting to visit other areas in Norfolk /suffolk border that offer evening entertainment but would love Hemsby to be offering this

Regards
Stella Sawyer
From Essex

Sent from Yahoo Mail for iPhone

14 SPRINGFIELD PARK ROAD
THE OLD SURGERY
CHELMSFORD
ESSEX .

Elaine M. Hignett

From: Gavin Dove <[REDACTED]>
Sent: 17 June 2023 20:08
To: licensing
Subject: Florida Club Licence

Hi,

I fully support the licence application for Florida Club in Hemsby.

Kind Regards,

Gavin Dove.

Sent from my iPhone

Elaine M. Hignett

From: krystle struffolino [REDACTED]
Sent: 17 June 2023 18:17
To: licensing
Subject: Hemsby Florida Club

Just to let you know that I fully support the opening of the florida club and also support the application for a late licence

Regards
Krystle

Elaine M. Hignett

From: linda.phipps [REDACTED]
Sent: 17 June 2023 17:25
To: licensing
Subject: License for florida club

I would just like to voice my support for the license application for Florida club in Hemsby. We have owned a holiday home here for several years and also own a holiday rental. We have enjoyed many evenings at the Florida club in the past with no detrimental effect to surrounding properties. The club will provide jobs for the local area and only be of benefit.

Please approve this application

Linda Phipps

14 PLANTAGENET SQUARE,
CAMP HILL, NORTHAMPTON .

Sent from Samsung Mobile on O2

Elaine M. Hignett

From: kay webb <[REDACTED]>
Sent: 17 June 2023 17:31
To: licensing
Subject: Florida club.

Just letting you know that I am in complete favour of the florida club opening for entertainment and selling of alcohol. It needs something like this on the florida holiday park..

Sent from Sky Yahoo Mail on Android

MS K. WEBB
15 MARSON GROVE
LUTON.

Elaine M. Hignett

From: Linda Rees [REDACTED]
Sent: 17 June 2023 17:42
To: licensing
Subject: Florida Park

Florida Park club house, This park needs to be opened up again, Has had late licence for a few years , I own a chalet on the park, never heard of any trouble or noise from it

LINDA REES
423 THE GLEBE
HEMSBY
NR29 4JA

Elaine M. Hignett

From: B. Firth [REDACTED]
Sent: 17 June 2023 18:03
To: licensing
Subject: The Florida club Hemsby

Hi there. I would just like to voice my opinion in regards to a late licence application for the Florida club in Hemsby. I think this would be great for our community having an extra venue for the locals and holiday makers, especially being able to stay open for longer as none of the other pubs choose not to. I fully back Scott Bensly and his family. He has put his time and energy into this project, and he has helped the community in other ways volunteering with R.N.L.I

So please consider his new venture.

Regards Bee

Elaine M. Hignett

From: David Parker [REDACTED]
Sent: 17 June 2023 18:05
To: licensing
Subject: Licence for Florida Club Hemsby

I fully support Scott Bensly in opening the Florida Club in Hemsby. He has put a lot of time into preparing the club and I look forward to having a quiet pint or two once he opens and I am sure he will do everything in his power to keep the peace with chalet owners nearby.

DAVID JOHN PARKER .
28 THE CLOSE
HEMSBY
NR29 4ER .

Elaine M. Hignett

From: Karen Clark <[REDACTED]>
Sent: 17 June 2023 17:14
To: licensing
Subject: The Florida Club Hemsby

Good evening,

I'm emailing with reference to the postponed licence for The Florida Club in Hemsby.

I'm saddened to hear a small minority has objected to Mr Scott Bensley obtaining a licence for this Club on a popular Chalet Park.

The Florida Club has had a late licence for as far back as I can remember and has given many memories including my own memories, over many years.

Mr Bensley has spent a vast amount of money revamping this Club to give people, and locals alike, the facility for live music and entertainment.

Please consider approving his licence.

Kind regards
Karen

Sent from [Outlook for Android](#)

Elaine M. Hignett

From: shelly unknown <[REDACTED]>
Sent: 17 June 2023 17:10
To: licensing
Subject: Late licence

To whom it may concern,

As a local i would like to express my full support for the late licence currently being applied for at the Florida Club in Hemsby.

This is just what is needed and will help encourage more holiday makers to stay and maybe raise more money to help the sea defence that is so desperately needed in Hemsby

I have a couple of caravans in Hemsby and lots of people have been sceptical to come due to the beach being closed this will definitely help when renting out my vans

Kind regards

Sent from Outlook for Android

Sent from Outlook for Android

Elaine M. Hignett

From: Michelle Higham <[REDACTED]>
Sent: 17 June 2023 17:07
To: licensing
Subject: Hemsby late licence

To whom it may concern,

I would like to express my support for the late licence being applied for at the Florida Club in Hemsby.

This is just what is needed, there is a lack of night time entertainment so will help encourage more holiday makers to visit

Kind regards

Sent from Outlook for Android

Elaine M. Hignett

From: mike higham <[REDACTED]>
Sent: 17 June 2023 17:04
To: licensing
Subject: Florida club licence

To whom it may concern,

Myself and my family would like to express our full support for the late licence currently being applied for at the Florida Club in Hemsby.

This is just what is needed and will help encourage more holiday makers to stay and spend their hard earned money in sunny Hemsby

I have 2 caravans in Hemsby and this will definitely help when advising my vans

Kind regards

Sent from Outlook for Android

Elaine M. Hignett

From: Sally Shorter [REDACTED]
Sent: 17 June 2023 16:57
To: licensing
Subject: Open Florida

We would love to see Florida club open again it's a vital part of hemsby and holiday makers enjoyment and fun I have worked in the Florida club over the years as an entertainer watch children grow into adults and bring their children in too great memories are made here x Sent from my iPhone

SALLY SHORTER.
13 BORTON ROAD
BLOFIELD HEATH
NORWICH.

Elaine M. Hignett

From: Carole Hilliard [REDACTED]
Sent: 19 June 2023 09:03
To: licensing
Subject: License

Categories: Green category

Good morning I am sending this email to whom it may concern we are a disabled couple who have been holidaying at Florida chalet holiday park hemsby for many years sometimes several times a year we depend on the clubhouse for entertainment socially and a couple of drinks because it is on site it means we don't have difficulty in having to either ordering taxis also expensive and leaving the park for this I understand that there has been a few people that do not want the clubhouse to open as usual the reason I do not know but I'm pretty sure it's a minor few kill joys what about belle air and seadells Richard sons etc the owner now has to attend a meeting with yourselves to see if he will be granted a license please can you consider this with all facts and peoples wishes a concerned holiday maker many regards and thank you in Advance

Sent from my iPhone

MR JOHN + MRS CAROLE HILLIARD.
EDGWARE
LONDON.

Elaine M. Hignett

From: nicola Brewer [REDACTED]
Sent: 20 June 2023 22:16
To: licensing
Subject: Florida Club, Hemsby

Categories: Green category

Dear Sir or Madam,

As a chalet owner in Hemsby, I fully support the Florida Club opening again, and I fully support it having a late licence. We enjoy spending our money in the Hemsby area, and it is a nice idea for another club to open to give us music and entertainments at night. I hope you approve the application.

Many thanks
Nicola Adams

470 SUNDOWNER HOLIDAY PARK
NEWPORT ROAD
HEMSBY
GREAT YARMOUTH.



Lisa Henry & Scott Bensly
The Florida Club
Florida Estate
Back Market Lane
Hemsby

20th June 2023
Ref: 091241

Dear Lisa Henry & Scott Bensly

APPLICATION FOR PREMISES LICENCE- The Florida Club

The Environmental Protection Team of Great Yarmouth Borough Council is a consultee for premises licence applications and considers issues surrounding the potential for public nuisances (including noise).

I am writing to advise that after reviewing the application submitted, the Environmental Protection Team has objected to your premises licence application due to concerns that the proposed hours requested for licensable activities has the potential for a noise nuisance to be created to local residents. However, I would like to try and seek an agreement to your licence conditions to remove the need for you to attend a subsequent licensing hearing.

Therefore, there are a number of additional conditions which I feel are necessary to be included on your operating schedule on the enclosed form. If you are happy for these conditions to be included on your premises licence, please can you arrange for this form to be signed, dated and the form returned to me by 3rd July 2023 at the latest. The form can be emailed to me with a digital signature if that is easier.

If you do not agree to these conditions to be included at this stage, I would be required to make a representation at the Licensing Committee.

Should you require any assistance in completing the form or require any further information, please do not hesitate to contact me.

Yours Sincerely,

Alick Miles- Senior Environmental Protection Officer
Phone: 01493 846390 Email: alick.miles@great-yarmouth.gov.uk

OPERATING SCHEDULE

CONDITIONS FOR PREVENTION OF PUBLIC NUISANCE AND PROMOTION OF PUBLIC SAFETY

Name of Premise: The Florida Club

Address of Premises: Florida Estate, Back Market Lane, Hemsby

	Proposed Condition
1	Noise or vibration from amplified music will not be audible at the façade of residential properties in the area.
2	Clear, legible and prominent notices will be displayed at all exits requesting persons to leave the premises and area quietly.
3	The placing of refuse, including glass bottles into receptacles, outside the premises must be carried out at a time that does not cause a public nuisance to neighbouring residents.

I agree that the above conditions will be included in my Operating Schedule and will therefore be subsequently included in any premises licence that is granted.

Name (please print): Scott Bensity Lisa Henry

Signature: 

Date: 28/6/23

Copies of this form must be sent to:

Environmental Services, Great Yarmouth Borough Council, - Town Hall, Hall Plain, Great Yarmouth,
Norfolk, NR30 2QF
Health@great-yarmouth.gov.uk



