

URN:

Subject: Application for variation of a premises licence : Cherry Tree Holiday Park, Mill Road, Burgh Castle, Great Yarmouth

Report to: Licensing Sub-Committee – 22 April 2024 Report by: Licensing Officer

SUBJECT MATTER AND DECISION REQUIRED

The Licensing Sub-Committee is asked to consider the premises licence variation application in relation to Cherry Tree Holiday Park, Mill Road, Burgh Castle, Great Yarmouth.

Recommendations:

It is recommended that the Sub-Committee determines the application for variation of the premises licence in accordance with one of the options set out in paragraph 4 below.

1. Application for a variation of a premises licence

- 1.1 Members are asked to consider an application made by Parkdean Caravan Parks Limited for a variation of the premises licence of Cherry Tree Holiday Park, Mill Road, Burgh Castle, Great Yarmouth.
- 1.2 The nature of the variation is:
 - The addition of: -
indoor sporting events, provision of anything similar to live, recorded music and performance of dance and wrestling,
Monday to Sunday, from 10.00 to 02.00 the following morning
Non standard timings of an additional hour on the morning British Summertime commences, and from the end of permitted hours on New Year's Eve to the start of permitted hours on New Year's Day.
 - The addition of: -
Late night refreshment – indoors
Monday to Sunday, from 23.00 to 02.00 the following morning
Non standard timings of an additional hour on the morning British Summertime commences, and from the end of permitted hours on New Year's Eve to the start of permitted hours on New Year's Day.

- To extend to outdoors: -
plays, films, live music, recorded music, performance of dance and provision of anything similar to live, recorded music and performance of dance,
Monday to Sunday, from 12.00 to 23.00.
- To amend the layout plans (both indoors and outdoors) as supplied to the Licensing Authority with the application
- To remove old obsolete or irrelevant conditions to be replaced with up to date and more appropriate conditions regarding door supervisors, safe occupancy, Challenge 25 and ID checks.

2. Background information

- 2.1 The application was sent to the Responsible Authorities, advertised by notice at the premise and in a newspaper and detailed on the Council's website.
- 2.2 Upon expiry of the 28 day representation period, five valid representations were received. Four representations are from local residents and one is from the parish council. Four of the representations are objecting to the application and one is in support but offers suggestions regarding the extent of the variation.

3. Additional papers

- 3.1 Premises licence variation application.
- 3.2 Copy of the current premises licence
- 3.3 Copies of the five representations.
- 3.4 Plan of the general location of the premises (outlined in red)

4. Options for Members

- 4.1 Grant the application on the terms requested.
- 4.2 Modify the conditions of the licence.
- 4.3 Reject the whole or part of the application.

Areas of consideration: e.g. does this report raise any of the following issues and if so how have these been considered/mitigated against?

Area for consideration	Comment
Monitoring Officer Consultation:	
Section 151 Officer Consultation:	

Existing Council Policies:	
Financial Implications (including VAT and tax):	None
Legal Implications (including human rights):	
Risk Implications:	
Equality Issues/EQIA assessment:	
Crime & Disorder:	
Every Child Matters:	

Application to vary a premises licence under the Licensing Act 2003

PLEASE READ THE FOLLOWING INSTRUCTIONS FIRST

Before completing this form please read the guidance notes at the end of the form.
If you are completing this form by hand please write legibly in block capitals. In all cases ensure that your answers are inside the boxes and written in black ink. Use additional sheets if necessary.

You may wish to keep a copy of the completed form for your records.

We Parkdean Caravan Parks Limited

being the premises licence holder, apply to vary a premises licence under section 34 of the Licensing Act 2003 for the premises described in Part 1 below

Premises licence number PL0425
--

Part 1 – Premises Details

Postal address of premises or, if none, ordnance survey map reference or description			
Cherry Tree Holiday Park Mill Road Burgh Castle			
Post town	Great Yarmouth	Post code	NR31 9QR

Telephone number at premises (if any)	01493 780229
Non-domestic rateable value of premises	£430,000

Part 2 – Applicant details

Daytime contact telephone number	0191 2560795		
E-mail address (optional)	licensing@parkdean-resorts.com		
Current residential address if different from premises address	2nd Floor 1 Gosforth Park Way Gosforth Business Park		
Post Town	Newcastle upon Tyne	Postcode	NE12 8ET

Part 3 - Variation

Please tick yes

Do you want the proposed variation to have effect as soon as possible?



If not, from what date do you want the variation to take effect?

Day			Month			Year		
<input type="text"/>	<input type="text"/>	<input type="text"/>	<input type="text"/>	<input type="text"/>	<input type="text"/>	<input type="text"/>	<input type="text"/>	<input type="text"/>

Do you want the proposed variation to have effect in relation to the introduction of the late night levy? (Please see guidance note 1) ☐ Yes ☒ No

Please describe briefly the nature of the proposed variation (Please read guidance note 2)

1. To add indoor sporting events, provision of anything similar to live, recorded music and performance of dance and wrestling Monday to Sunday 1000 to 0200 the following morning, an additional hour on the morning British Summertime commences and from the end of permitted hours on New Year's Eve to the start of permitted hours on New Year's Day;
2. To extend plays, films, live music, recorded music, performance of dance and provision of anything similar to live, recorded music and performance of dance outdoors Monday to Sunday 1200 to 2300; to add late night refreshment indoors Monday to Sunday 2300 to 0200 the following morning, an additional hour on the morning British Summertime commences and from the end of permitted hours on New Year's Eve to the start of permitted hours on New Year's Day;
3. To amend the layout plans (both indoors and outdoors) as supplied to the Licensing Authority with this application;
4. To remove old obsolete or irrelevant conditions to be replaced with up to date and more appropriate conditions regarding doors supervisors, safe occupancy, Challenge 25 and ID checks.

All other existing licensable activities, hours and conditions to remain as existing.

If your proposed variation would mean that 5,000 or more people are expected to attend the premises at any one time, please state the number expected to attend

N/A

Part 4 Operating Schedule

Please complete those parts of the Operating Schedule below which would be subject to change if this application to vary is successful.

Provision of regulated entertainment (Please read guidance note 3)

- | | |
|---|-------------------------------------|
| a) plays (if ticking yes, fill in box A) | <input checked="" type="checkbox"/> |
| b) films (if ticking yes, fill in box B) | <input checked="" type="checkbox"/> |
| c) indoor sporting events (if ticking yes, fill in box C) | <input checked="" type="checkbox"/> |
| d) boxing or wrestling entertainment (if ticking yes, fill in box D) | <input checked="" type="checkbox"/> |
| e) live music (if ticking yes, fill in box E) | <input checked="" type="checkbox"/> |
| f) recorded music (if ticking yes, fill in box F) | <input checked="" type="checkbox"/> |
| g) performances of dance (if ticking yes, fill in box G) | <input checked="" type="checkbox"/> |
| h) anything of a similar description to that falling within (e), (f) or (g) (if ticking yes, fill in box H) | <input checked="" type="checkbox"/> |

Please tick all that apply

Provision of late night refreshment (if ticking yes, fill in box I)

☒

Sale by retail of alcohol (if ticking yes, fill in box J)

☐

In all cases complete boxes K, L and M

A

Plays Standard days and timings (please read guidance note 8)			Will the performance of a play take place indoors or outdoors or both – please tick (please read guidance note 4)		Indoors	<input type="checkbox"/>
					Outdoors	<input type="checkbox"/>
Day	Start	Finish			Both	<input checked="" type="checkbox"/>
Mon	NO CHANGE		Please give further details here (please read guidance note 5) AS EXISTING			
Tue	NO CHANGE					
Wed	NO CHANGE		State any seasonal variations for performing plays (please read guidance note 6)			
Thur	NO CHANGE					
Fri	NO CHANGE		Non standard timings. Where you intend to use the premises for the performance of plays at different times to those listed in the column on the left, please list (please read guidance note 7) Outdoors – 1200 to 2300 From the end of permitted hours on New Year's Eve to the start of permitted hours on New Year's Day An additional hour to the standard and non-standard timings on the day when British Summertime commences.			
Sat	NO CHANGE					
Sun	NO CHANGE					

B

Films Standard days and timings (please read guidance note 8)			Will the exhibition of films take place indoors or outdoors or both – please tick (please read guidance note 4)		Indoors	<input type="checkbox"/>
					Outdoors	<input type="checkbox"/>
Day	Start	Finish			Both	<input checked="" type="checkbox"/>
Mon	NO CHANGE		Please give further details here (please read guidance note 5) AS EXISTING			
Tue	NO CHANGE					
Wed	NO CHANGE		State any seasonal variations for the exhibition of films (please read guidance note 6)			
Thur	NO CHANGE					
Fri	NO CHANGE		Non standard timings. Where you intend to use the premises for the exhibition of films at different times to those listed in the column on the left, please list (please read guidance note 7) Outdoors – 1200 to 2300 From the end of permitted hours on New Year's Eve to the start of permitted hours on New Year's Day An additional hour to the standard and non-standard timings on the day when British Summertime commences.			
Sat	NO CHANGE					
Sun	NO CHANGE					

C

Indoor sporting events Standard days and timings (please read guidance note 8)			Please give further details (please read guidance note 5) Family Entertainment Sporting Events and Entertainment from staff and performers
Day	Start	Finish	
Mon	10:00	02:00	
Tue	10:00	02:00	State any seasonal variations for indoor sporting events (please read guidance note 6)
Wed	10:00	02:00	
Thur	10:00	02:00	Non standard timings. Where you intend to use the premises for indoor sporting events at different times to those listed in the column on the left, please list (please read guidance note 7) From the end of permitted hours on New Year's Eve to the start of permitted hours on New Year's Day An additional hour to the standard and non-standard timings on the day when British Summertime commences.
Fri	10:00	02:00	
Sat	10:00	02:00	
Sun	10:00	02:00	

D

Boxing or wrestling entertainments Standard days and timings (please read guidance note 8)			Will the boxing or wrestling entertainment take place indoors or outdoors or both – please tick (please read guidance note 4)	
Day	Start	Finish	Indoors	<input checked="" type="checkbox"/>
			Outdoors	<input type="checkbox"/>
			Both	<input type="checkbox"/>
Mon	10:00	02:00	Please give further details here (please read guidance note 5) WRESTLING ONLY – FAMILY ENTERTAINMENT	
Tue	10:00	02:00		
Wed	10:00	02:00	State any seasonal variations for boxing or wrestling entertainment (please read guidance note 6)	
Thur	10:00	02:00		
Fri	10:00	02:00	Non standard timings. Where you intend to use the premises for boxing or wrestling entertainment at different times to those listed in the column on the left, please list (please read guidance note 7) From the end of permitted hours on New Year's Eve to the start of permitted hours on New Year's Day An additional hour to the standard and non-standard timings on the day when British Summertime commences.	
Sat	10:00	02:00		
Sun	10:00	02:00		

E

Live music Standard days and timings (please read guidance note 8)			Will the performance of live music take place indoors or outdoors or both – please tick (please read guidance note 4)		Indoors	<input type="checkbox"/>
					Outdoors	<input type="checkbox"/>
					Both	<input checked="" type="checkbox"/>
Day	Start	Finish				
Mon	NO CHANGE		Please give further details here (please read guidance note 5) AS EXISTING			
Tue	NO CHANGE					
Wed	NO CHANGE		State any seasonal variations for the performance of live music (please read guidance note 6)			
Thur	NO CHANGE					
Fri	NO CHANGE		Non standard timings. Where you intend to use the premises for the performance of live music at different times to those listed in the column on the left, please list (please read guidance note 7) Outdoors – 1200 to 2300 From the end of permitted hours on New Year's Eve to the start of permitted hours on New Year's Day An additional hour to the standard and non-standard timings on the day when British Summertime commences.			
Sat	NO CHANGE					
Sun	NO CHANGE					

F

Recorded music Standard days and timings (please read guidance note 8)			Will the playing of recorded music take place indoors or outdoors or both – please tick (please read guidance note 4)		Indoors	<input type="checkbox"/>
					Outdoors	<input type="checkbox"/>
					Both	<input checked="" type="checkbox"/>
Day	Start	Finish				
Mon	NO CHANGE		Please give further details here (please read guidance note 5) AS EXISTING			
Tue	NO CHANGE					
Wed	NO CHANGE		State any seasonal variations for the playing of recorded music (please read guidance note 6)			
Thur	NO CHANGE					
Fri	NO CHANGE		Non standard timings. Where you intend to use the premises for the playing of recorded music at different times to those listed in the column on the left, please list (please read guidance note 7) Outdoors – 1200 to 2300 From the end of permitted hours on New Year's Eve to the start of permitted hours on New Year's Day An additional hour to the standard and non-standard timings on the day when British Summertime commences.			
Sat	NO CHANGE					
Sun	NO CHANGE					

G

Performances of dance Standard days and timings (please read guidance note 8)			Will the performance of dance take place indoors or outdoors or both – please tick (please read guidance note 4)	Indoors	<input type="checkbox"/>
				Outdoors	<input type="checkbox"/>
				Both	<input checked="" type="checkbox"/>
Day	Start	Finish			
Mon	NO CHANGE		Please give further details here (please read guidance note 5) AS EXISTING		
Tue	NO CHANGE				
Wed	NO CHANGE		State any seasonal variations for the performance of dance (please read guidance note 6)		
Thur	NO CHANGE				
Fri	NO CHANGE		Non standard timings. Where you intend to use the premises for the performance of dance at different times to those listed in the column on the left, please list (please read guidance note 7) Outdoors – 1200 to 2300 From the end of permitted hours on New Year's Eve to the start of permitted hours on New Year's Day An additional hour to the standard and non-standard timings on the day when British Summertime commences.		
Sat	NO CHANGE				
Sun	NO CHANGE				

H

Anything of a similar description to that falling within (e), (f) or (g) Standard days and timings (please read guidance note 8)			Please give a description of the type of entertainment you will be providing Entertainment not covered under e, f or g above		
Day	Start	Finish	Will this entertainment take place indoors or outdoors or both – please tick (please read guidance note 4)	Indoors	<input type="checkbox"/>
Mon	10:00	02:00		Outdoors	<input type="checkbox"/>
				Both	<input checked="" type="checkbox"/>
Tue	10:00	02:00	Please give further details here (please read guidance note 5)		
Wed	10:00	02:00			
Thur	10:00	02:00	State any seasonal variations for entertainment of a similar description to that falling within (e), (f) or (g) (please read guidance note 6)		
Fri	10:00	02:00			
Sat	10:00	02:00	Non standard timings. Where you intend to use the premises for the entertainment of a similar description to that falling within (e),		
Sun	10:00	02:00			

		<p>(f) or (g) at different times to those listed in the column on the left. please list (please read guidance note 7)</p> <p>Outdoors – 1200 to 2300</p> <p>From the end of permitted hours on New Year's Eve to the start of permitted hours on New Year's Day</p> <p>An additional hour to the standard and non-standard timings on the day when British Summertime commences.</p>
--	--	---

Late night refreshment Standard days and timings (please read guidance note 8)			Will the provision of late night refreshment take place indoors or outdoors or both – please tick (please read guidance note 4)	Indoors <input checked="" type="checkbox"/> Outdoors <input type="checkbox"/> Both <input type="checkbox"/>
Day	Start	Finish		
Mon	23:00	02:00	Please give further details here (please read guidance note 5) Hot food and drink provided throughout the holiday park	
Tue	23:00	02:00		
Wed	23:00	02:00	State any seasonal variations for the provision of late night refreshment (please read guidance note 6)	
Thur	23:00	02:00		
Fri	23:00	02:00	Non standard timings. Where you intend to use the premises for the provision of late night refreshment at different times to those listed in the column on the left, please list (please read guidance note 7) From the end of permitted hours on New Year's Eve to the start of permitted hours on New Year's Day An additional hour to the standard and non-standard timings on the day when British Summertime commences.	
Sat	23:00	02:00		
Sun	23:00	02:00		

J – NO CHANGE

Supply of alcohol Standard days and timings (please read guidance note 8)			Will the supply of alcohol be for consumption (Please tick box) (please read guidance note 9)	On the premises <input type="checkbox"/> Off the premises <input type="checkbox"/> Both <input type="checkbox"/>
Day	Start	Finish		
Mon			State any seasonal variations for the supply of alcohol (please read guidance note 6)	
Tue				
Wed				
Thur			Non-standard timings. Where you intend to use the premises for the supply of alcohol at different times to those listed in the column on the left, please list (please read guidance note 7)	
Fri				
Sat				
Sun				

K

Please highlight any adult entertainment or services, activities, other entertainment or matters ancillary to the use of the premises that may give rise to concern in respect of children (please read guidance note 8)

NONE

L

Hours premises are open to the public Standard days and timings (please read guidance note 8)			State any seasonal variations (please read guidance note 6)
Day	Start	Finish	<p>Non standard timings. Where you intend the premises to be open to the public at different times from those listed in the column on the left, please list (please read guidance note 7)</p> <p>From the end of permitted hours on New Year's Eve to the start of permitted hours on New Year's Day</p> <p>An additional hour to the standard and non-standard timings on the day when British Summertime commences.</p>
Mon	08:00	02:30	
Tue	08:00	02:30	
Wed	08:00	02:30	
Thur	08:00	02:30	
Fri	08:00	02:30	
Sat	08:00	02:30	
Sun	08:00	02:30	

Please identify those conditions currently imposed on the licence which you believe could be removed as a consequence of the proposed variation you are seeking

The following conditions to be removed from the Premises Licence in their entirety to be replaced with the conditions proposed in this application:-

1. From 18.00 two door supervisors shall be on duty. A register of names will be kept along with times they were on duty. The door staff shall carry their proof of registration with the SIA and wear their name badges at all times.
2. Consideration will be given to fixing a capacity limit after consultation with the fire service, if deemed necessary
3. There shall be sufficient adequately trained staff to ensure safe evacuation from the premises in the event of an emergency.
4. All fire escape routes shall be kept unobstructed and be clearly identifiable.
5. All fire exit doors shall be capable of opening without use of any key, card, code or similar means.
6. Hangings, curtains and temporary decorations shall be maintained in a flame-retardant condition and shall not obstruct fire exits, fire safety signs or firefighting equipment.
7. All upholstered seating shall comply with current fire safety regulations.

8. Fire evacuation tests shall be carried out every 6 months and a record kept, all firefighting equipment and emergency lighting shall be maintained in good working order.
9. At least one first aider shall be on duty.
10. Fire doors will be self-closing and shall not be held open other than by devices approved by the Fire Service or Health and Safety department.
11. Edges to steps and stairways shall be maintained so as to be conspicuous.
12. The premises shall observe the Portman Group's code of practice on the naming, packaging and promotion of alcoholic drinks.
13. An adequate supply of free drinking water shall be provided for customers.
14. The premises shall operate a photographic proof of age scheme.
15. Where performances are presented especially for unaccompanied children there shall be at least one attendant for every 50 children or part thereof.
16. All staff working in the Entertainment venues or security staff must provide Parkdean Caravan Parks Limited with a Criminal Record Bureau Check.

Please tick yes

- I have enclosed the premises licence ☒
- I have enclosed the relevant part of the premises licence ☐

If you have not ticked one of these boxes please fill in reasons for not including the licence, or part of it, below

Reasons why I have failed to enclose the premises licence or relevant part of premises licence

M Describe any additional steps you intend to take to promote the four licensing objectives as a result of the proposed variation:

a) General – all four licensing objectives (b,c,d,e) (please read guidance note 11)

Bearing in mind the nature of this variation and those conditions to remain on the Premises Licence, nothing further is required save for the further proposed conditions listed below.

b) The prevention of crime and disorder

1. When door supervisors are on duty a record will be kept (written/electronic) of their identity, SIA licence number, times they were on duty and details of any employer (other than the licensee or an associated group company of the licensee). Records will be kept for a period of 12 months and will be made available upon request to an authorised officer of the local authority or Police.
2. When on duty all door supervisors are to wear their SIA licences in a clearly visible position.

c) Public safety

1. A Fire Risk Assessment will be carried out to determine the safe occupancy figures for the premises. This assessment will be reviewed and updated as and when required.

d) The prevention of public nuisance

See boxes a), b), c) and e)

e) The protection of children from harm

1. The premises will operate a Challenge 25 proof of age policy.
2. Any person who appears to be under 25 will be required to produce proof of age before they are allowed to purchase or consume alcohol. The forms of proof of age that will be accepted are a passport, photo driving licence, an ID card bearing a PASS hologram or a MOD Form 90 military ID card.
3. All employees who are entertainers or security staff are to be DBS checked.

Please tick yes

- I have made or enclosed payment of the fee or ☒
- I have not made or enclosed payment of the fee because this application has been made in relation to the introduction of the late night levy ☒
- I have sent copies of this application and the plan to responsible authorities and others where applicable ☒
- I understand that I must now advertise my application ☒
- I have enclosed the premises licence or relevant part of it or explanation ☒
- I understand that if I do not comply with the above requirements my application will be rejected ☒

IT IS AN OFFENCE, UNDER SECTION 158 OF THE LICENSING ACT 2003, TO MAKE A FALSE STATEMENT IN OR IN CONNECTION WITH THIS APPLICATION. THOSE WHO MAKE A FALSE STATEMENT MAY BE LIABLE ON SUMMARY CONVICTION TO A FINE OF ANY AMOUNT.

Part 5 – Signatures (please read guidance note 12)

Signature of applicant (the current premises licence holder) or applicant's solicitor or other duly authorised agent (please read guidance note 13). If signing on behalf of the applicant please state in what capacity.

Signature	
Date	08/02/2024
Capacity	Poppleston Allen – Solicitors for & on behalf of the applicant

Where the premises licence is jointly held signature of 2nd applicant (the current premises licence holder) or 2nd applicant's solicitor or other authorised agent (please read guidance note 14). If signing on behalf of the applicant please state in what capacity.

Signature	
Date	
Capacity	

Contact name (where not previously given) and address for correspondence associated with this application (please read guidance note 15)			
[REDACTED] Poppleston Allen Solicitors 37 Stoney Street The Lace Market			
Post town	Nottingham	Post code	NG1 1LS
Telephone number (if any)	[REDACTED]		
If you would prefer us to correspond with you by e-mail your e-mail address (optional)			
[REDACTED]			

Notes for Guidance

This application cannot be used to vary the licence so as to extend the period for which the licence has effect or to vary substantially the premises to which it relates. If you wish to make that type of change to the premises licence you should make a new premises licence application under section 17 of the Licensing Act 2003.

1. You do not have to pay a fee if the only purpose of the variation for which you are applying is to avoid becoming liable for the late night levy
2. Describe the premises. For example the type of premises, its general situation and layout and any other information which could be relevant to the licensing objectives. Where your application includes off-supplies of alcohol and you intend to provide a place for consumption of these off-supplies you must include a description of where the place will be and its proximity to the premises.
3. In terms of specific regulated entertainments please note that:
 - Plays: no licence is required for performances between 08.00 and 23.00 on any day, provided that the audience does not exceed 500.
 - Films: no licence is required for 'not-for-profit' film exhibition held in community premises between 08.00 and 23.00 on any day provided that the audience does not exceed 500 and the organiser (a) gets consent to the screening from a person who is responsible for the premises; and (b) ensures that each such screening abides by age classification ratings.
 - Indoor sporting events: no licence is required for performances between 08.00 and 23.00 on any day, provided that the audience does not exceed 1000.
 - Boxing or Wrestling Entertainment: no licence is required for a contest, exhibition or display of Greco-Roman wrestling, or freestyle wrestling between 08.00 and 23.00 on any day, provided that the audience does not exceed 1000. Combined fighting sports – defined as a contest, exhibition or display which combines boxing or wrestling with one or more martial arts – are licensable as a boxing or wrestling entertainment rather than an indoor sporting event.
 - Live music: no licence permission is required for:
 - a performance of unamplified live music between 08.00 and 23.00 on any day, on any premises.
 - a performance of amplified live music between 08.00 and 23.00 on any day on premises authorised to sell alcohol for consumption on those premises, provided that the audience does not exceed 500.
 - a performance of amplified live music between 08.00 and 23.00 on any day, in a workplace that is not licensed to sell alcohol on those premises, provided that the audience does not exceed 500.
 - a performance of amplified live music between 08.00 and 23.00 on any day, in a church hall, village hall, community hall, or other similar community premises, that is not licensed by a premises licence to sell alcohol, provided that (a) the audience does not exceed 500, and (b) the organiser gets consent for the performance from a person who is responsible for the premises.
 - a performance of amplified live music between 08.00 and 23.00 on any day, at the non-residential premises of (i) a local authority, or (ii) a school, or (iii) a

hospital, provided that (a) the audience does not exceed 500, and (b) the organiser gets consent for the performance on the relevant premises from: (i) the local authority concerned, or (ii) the school or (iii) the health care provider for the hospital.

- **Recorded Music:** no licence permission is required for:
 - any playing of recorded music between 08.00 and 23.00 on any day on premises authorised to sell alcohol for consumption on those premises, provided that the audience does not exceed 500.
 - any playing of recorded music between 08.00 and 23.00 on any day, in a church hall, village hall, community hall, or other similar community premises, that is not licensed by a premises licence to sell alcohol, provided that (a) the audience does not exceed 500, and (b) the organiser gets consent for the performance from a person who is responsible for the premises.
 - any playing of recorded music between 08.00 and 23.00 on any day, at the non-residential premises of (i) a local authority, or (ii) a school, or (iii) a hospital, provided that (a) the audience does not exceed 500, and (b) the organiser gets consent for the performance on the relevant premises from: (i) the local authority concerned, or (ii) the school proprietor or (iii) the health care provider for the hospital.
 - **Dance:** no licence is required for performances between 08.00 and 23.00 on any day, provided that the audience does not exceed 500. However, a performance which amounts to adult entertainment remains licensable.
 - **Cross activity exemptions:** no licence is required between 08.00 and 23.00 on any day, with no limit on audience size for:
 - any entertainment taking place on the premises of the local authority where the entertainment is provided by or on behalf of the local authority;
 - any entertainment taking place on the hospital premises of the health care provider where the entertainment is provided by or on behalf of the health care provider;
 - any entertainment taking place on the premises of the school where the entertainment is provided by or on behalf of the school proprietor; and
 - any entertainment (excluding films and a boxing or wrestling entertainment) taking place at a travelling circus, provided that (a) it takes place within a moveable structure that accommodates the audience, and (b) that the travelling circus has not been located on the same site for more than 28 consecutive days.
4. Where taking place in a building or other structure please tick as appropriate.
Indoors may include a tent.
 5. For example state type of activity to be authorised, if not already stated, and give relevant further details, for example (but not exclusively) whether or not music will be amplified or unamplified.
 6. For example (but not exclusively), where the activity will occur on additional days during the summer months.
 7. For example (but not exclusively), where you wish the activity to go on longer on a particular day e.g. Christmas Eve.
 8. Please give timings in 24 hour clock (e.g. 16:00) and only give details for the days of the week when you intend the premises to be used for the activity.
 9. If you wish people to be able to consume alcohol on the premises please tick on, if you wish people to be able to purchase alcohol to consume away from the premises please tick off. If you wish people to be able to do both please tick both.
 10. Please give information about anything intended to occur at the premises or ancillary to the use of the premises which may give rise to concern in respect of children regardless of whether you intend children to have access to the premises, for example (but not exclusively) nudity or semi-nudity, films for restricted age groups or the presence of gaming machines.
 11. Please list here steps you will take to promote all four licensing objectives together.
 12. The application form must be signed.
 13. An applicant's agent (for example solicitor) may sign the form on their behalf provided that they have actual authority to do so.

Welcome to

Cherry Tree

Outdoor area for all licensed activities

Any enquiries? Please ask at on-call reception - they'll be happy to help!

01493 780 229

07921 885 100



The essentials

- R Reception
- SG Holiday Home Sales Showground
- P Holiday Home Sales Enquiry Centre
- Coast Bar & Kitchen
- Store
- Showbar
- Indoor swimming pool/Heated outdoor swimming pool
- Outdoor play area
- Amusements
- Crazy golf
- Multi-sports court
- Laundrette
- Disabled access
- Disabled toilets
- Parking
- Disabled parking
- Fire extinguisher
- Fire hose
- Recycling/general waste point



Scan the QR code above to download this map



Scan the QR code above to pre-book your activities or visit one of our on-park booking hubs.



Please note - Passes are required for admission to all facilities. Activities and facilities vary by date.

5 Speed limit around the park is 5mph

Please drive safely around the park. Quad bikes, mopeds, motorbikes, scooters and similar vehicles, along with commercial vehicles or parking vehicles including large cars are not permitted on park.

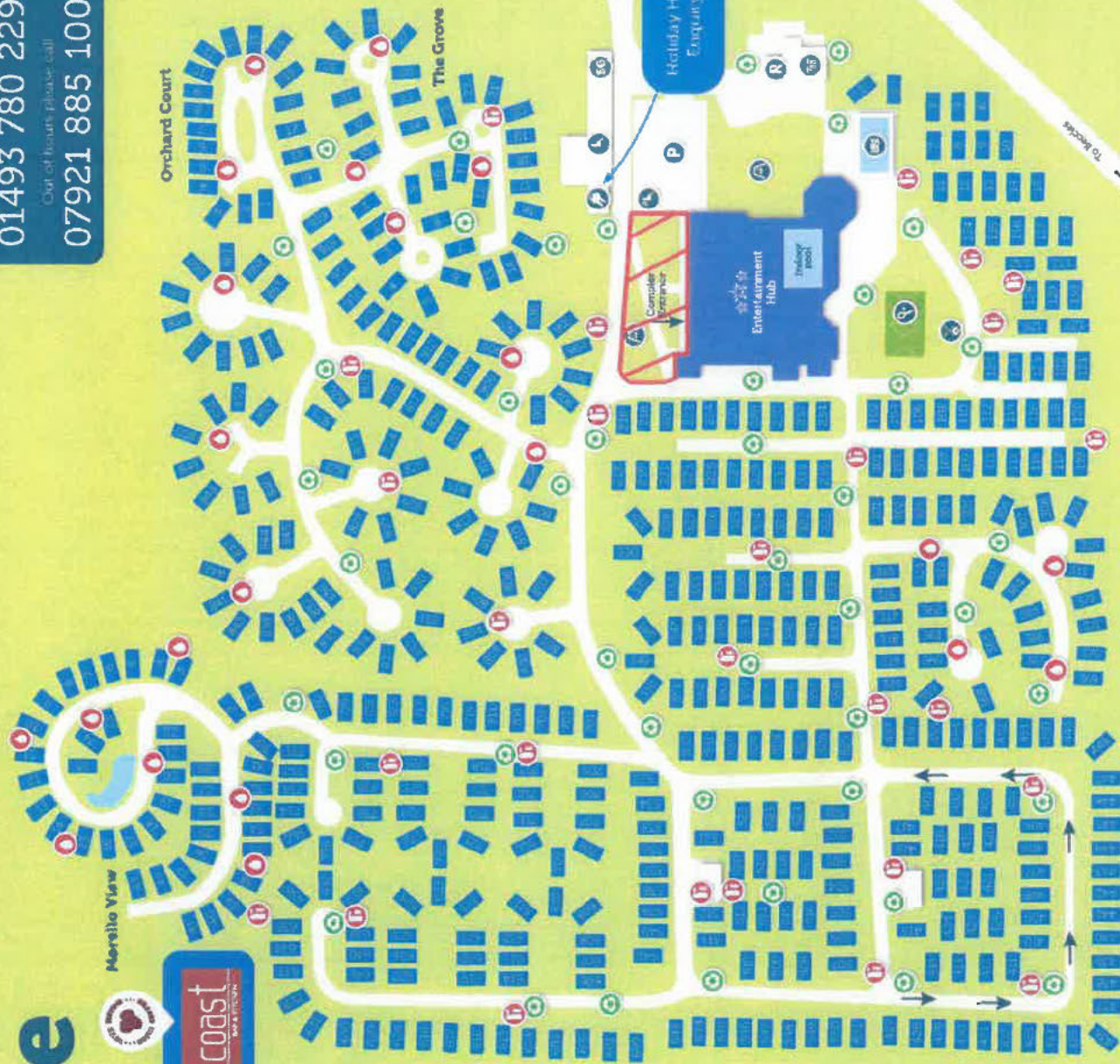



Licensing Act 2003
Premises Licence

PL0425

Part 1 - Premises Details

POSTAL ADDRESS OF PREMISES, OR IF NONE, ORDNANCE SURVEY MAP REFERENCE OR DESCRIPTION

Cherry Tree Holiday Park

Mill Road, Burgh Castle, Norfolk, NR31 9QR.

Telephone 780024

WHERE THE LICENCE IS TIME LIMITED THE DATES

Not applicable

LICENSABLE ACTIVITIES AUTHORISED BY THE LICENCE

- a performance of a play
- an exhibition of a film
- a performance of live music
- any playing of recorded music
- a performance of dance
- the supply of alcohol

THE TIMES THE LICENCE AUTHORISES THE CARRYING OUT OF LICENSABLE ACTIVITIES

Activity (and Area if applicable)	Description	Time From	Time To
A. Performance of a play (Indoors)			
	Sunday	10:00am	2:00am
	Monday	10:00am	2:00am
	Tuesday	10:00am	2:00am
	Wednesday	10:00am	2:00am
	Thursday	10:00am	2:00am
	Friday	10:00am	2:00am
	Saturday	10:00am	2:00am
	Non Standard Timings: Morning of BST	10:00am	3:00am
	Non Standard Timings: New Years Eve	10:00am	10:00am
B. Exhibition of films (Indoors)			
	Sunday	10:00am	2:00am
	Monday	10:00am	2:00am
	Tuesday	10:00am	2:00am
	Wednesday	10:00am	2:00am
	Thursday	10:00am	2:00am
	Friday	10:00am	2:00am
	Saturday	10:00am	2:00am
	Non Standard Timings: Morning of BST	10:00am	3:00am
	Non Standard Timings: New Years Eve	10:00am	10:00am
E. Performance of live music (Indoors)			
	Sunday	10:00am	2:00am
	Monday	10:00am	2:00am
	Tuesday	10:00am	2:00am
	Wednesday	10:00am	2:00am





Licensing Act 2003
Premises Licence

PL0425

THE TIMES THE LICENCE AUTHORISES THE CARRYING OUT OF LICENSABLE ACTIVITIES continued ...

Activity (and Area if applicable)	Description	Time From	Time To
E. Performance of live music (Indoors)	continued ...		
	Thursday	10:00am	2:00am
	Friday	10:00am	2:00am
	Saturday	10:00am	2:00am
	Non Standard Timings: Morning of BST	10:00am	3:00am
	Non Standard Timings: New Years Eve	10:00am	10:00am
F. Playing of recorded music (Indoors)	Sunday	10:00am	2:00am
	Monday	10:00am	2:00am
	Tuesday	10:00am	2:00am
	Wednesday	10:00am	2:00am
	Thursday	10:00am	2:00am
	Friday	10:00am	2:00am
	Saturday	10:00am	2:00am
	Non Standard Timings: Morning of BST	10:00am	3:00am
	Non Standard Timings: New Years Eve	10:00am	10:00am
G. Performance of dance (Indoors)	Sunday	10:00am	2:00am
	Monday	10:00am	2:00am
	Tuesday	10:00am	2:00am
	Wednesday	10:00am	2:00am
	Thursday	10:00am	2:00am
	Friday	10:00am	2:00am
	Saturday	10:00am	2:00am
	Non Standard Timings: Morning of BST	10:00am	3:00am
	Non Standard Timings: New Years Eve	10:00am	10:00am
J. Supply of alcohol for consumption ON and OFF the premises	Sunday	10:00am	2:00am
	Monday	10:00am	2:00am
	Tuesday	10:00am	2:00am
	Wednesday	10:00am	2:00am
	Thursday	10:00am	2:00am
	Friday	10:00am	2:00am
	Saturday	10:00am	2:00am
	Non Standard Timings: Morning of BST	10:00am	3:00am
	Non Standard Timings: New Years Eve	10:00am	10:00am

THE OPENING HOURS OF THE PREMISES

Description	Time From	Time To
Sunday	8:00am	2:30am
Monday	8:00am	2:30am





Licensing Act 2003
Premises Licence

PL0425

THE OPENING HOURS OF THE PREMISES continued ...

Description	Time From	Time To
Tuesday	8:00am	2:30am
Wednesday	8:00am	2:30am
Thursday	8:00am	2:30am
Friday	8:00am	2:30am
Saturday	8:00am	2:30am
Non Standard Timings: Morning of BST	8:00am	3:30am
New Years Eve	8:00am	8:00am

WHERE THE LICENCE AUTHORISES SUPPLIES OF ALCOHOL WHETHER THESE ARE ON AND / OR OFF SUPPLIES

- J. Supply of alcohol for consumption ON and OFF the premises

Part 2

NAME, (REGISTERED) ADDRESS, TELEPHONE NUMBER AND EMAIL (WHERE RELEVANT) OF HOLDER OF PREMISES LICENCE

Parkdean Caravan Parks Limited 2nd Floor, 1, Gosforth Park Way, Gosforth Business Park, Newcastle upon Tyne, NE12 8ET.
juditharchibold@parkdeanholidays Telephone 0191 2560768

REGISTERED NUMBER OF HOLDER, FOR EXAMPLE COMPANY NUMBER, CHARITY NUMBER (WHERE APPLICABLE)

Parkdean Caravan Parks Limited 5231267

NAME, ADDRESS AND TELEPHONE NUMBER OF DESIGNATED PREMISES SUPERVISOR WHERE THE PREMISES LICENCE AUTHORISES THE SUPPLY OF ALCOHOL

Thomas Bernard BARRON

PERSONAL LICENCE NUMBER AND ISSUING AUTHORITY OF PERSONAL LICENCE HELD BY DESIGNATED PREMISES SUPERVISOR WHERE THE PREMISES LICENCE AUTHORISES FOR THE SUPPLY OF ALCOHOL

Licence No. PA1659

Issued by Great Yarmouth

ANNEXES

MANDATORY CONDITIONS RELATING TO THE SUPPLY OF ALCOHOL (ON-SALES)

1. No supply of alcohol may be made under the premises licence:
 - At a time when there is no designated premises supervisor in respect of the premises licence, or
 - At a time when the designated premises supervisor does not hold a personal licence or his personal licence is suspended.
2. Every supply of alcohol under the premises licence must be made or authorised by a person who holds a personal licence.





Licensing Act 2003
Premises Licence

PL0425

ANNEXES continued ...

3. The responsible person must ensure that staff on relevant premises do not carry out, arrange or participate in any irresponsible promotions in relation to the premises.
4. An irresponsible promotion means any one or more of the following activities, or substantially similar activities, carried on for the purpose of encouraging the sale or supply of alcohol for consumption on the premises:
 - (a) Games or other activities which require or encourage, or are designed to require or encourage, individuals to:
 - (i) drink a quantity of alcohol within a time limit (other than to drink alcohol sold or supplied on the premises before the cessation of the period in which the responsible person is authorised to sell or supply alcohol), or
 - (ii) drink as much alcohol as possible (whether within a time limit or otherwise);
 - (b) Provision of unlimited or unspecified quantities of alcohol free or for a fixed or discounted fee to the public or to a group defined by a particular characteristic in a manner which carries a significant risk of undermining a licensing objective;
 - (c) Provision of free or discounted alcohol or any other thing as a prize to encourage or reward the purchase and consumption of alcohol over a period of 24 hours or less in a manner which carries a significant risk of undermining a licensing objective;
 - (d) selling or supplying alcohol in association with promotional posters or flyers on, or in the vicinity of, the premises which can reasonably be considered to condone, encourage or glamorise anti-social behaviour or to refer to the effects of drunkenness in any favourable manner.
 - (e) dispensing alcohol directly by one person into the mouth of another (other than where that person is unable to drink without assistance by reason of disability);
5. The responsible person must ensure that free potable water is provided on request to customers where it is reasonably available.
6.
 - (a) The premises licence holder must ensure that an age verification policy is adopted in respect of the premises in relation to the sale or supply of alcohol.
 - (b) The designated premises supervisor in relation to the premises licence must ensure that the supply of alcohol at the premises is carried on in accordance with the age verification policy.



Licensing Act 2003

Premises Licence

PL0425

ANNEXES continued ...

(c) The policy must require individuals who appear to the responsible person to be under 18 years of age (or such older age as may be specified in the policy) to produce on request, before being served alcohol, identification bearing their photograph, date of birth and either -

a holographic mark or an ultraviolet feature.

7. The responsible person must ensure that:

(a) where any of the following alcoholic drinks is sold or supplied for consumption on the premises (other than alcoholic drinks sold or supplied having been made up in advance ready for sale or supply in a securely closed container) it is available to customers in the following measures-

- (i) beer or cider: ½ pint;
- (ii) gin, rum, vodka or whisky: 25 ml or 35 ml; and
- (iii) still wine in a glass: 125 ml; and

(b) these measures are displayed in a menu, price list or other printed material which is available to customers on the premises; and

(c) where a customer does not in relation to a sale of alcohol specify the quantity of alcohol to be sold, the customer is made aware that these measures are available.

8. A relevant person shall ensure that no alcohol is sold or supplied for consumption on or off the premises for a price which is less than the permitted price.

9. For the purposes of the condition set out in paragraph 9-

(a) "duty" is to be construed in accordance with the Alcoholic Liquor Duties Act 1979;

(b) "permitted price" is the price found by applying the formula-

$$P = D + (D \times V)$$

where-

- (i) P is the permitted price,
- (ii) D is the amount of duty chargeable in relation to the alcohol as if the duty were charged on the date of the sale or supply of the alcohol, and
- (iii) V is the rate of value added tax chargeable in relation to the alcohol as if the value added tax were charged on the date of the sale or supply of the alcohol;





Licensing Act 2003
Premises Licence

PL0425

ANNEXES continued ...

(c) "relevant person" means, in relation to premises in respect of which there is in force a premises licence-

- (i) the holder of the premises licence,
- (ii) the designated premises supervisor (if any) in respect of such a licence, or
- (iii) the personal licence holder who makes or authorises a supply of alcohol under such a licence;

(d) "relevant person" means, in relation to premises in respect of which there is in force a club premises certificate, any member or officer of the club present on the premises in a capacity which enables the member or officer to prevent the supply in question; and

(e) "value added tax" means value added tax charged in accordance with the Value Added Tax Act 1994.

10. Where the permitted price given by Paragraph (b) of paragraph 10 would (apart from this paragraph) not be a whole number of pennies, the price given by that sub-paragraph shall be taken to be the price actually given by that sub-paragraph rounded up to the nearest penny.
11. -(1) Sub-paragraph (2) applies where the permitted price given by Paragraph (b) of paragraph 10 on a day ("the first day") would be different from the permitted price on the next day ("the second day") as a result of a change to the rate of duty or value added tax.
- (2) The permitted price which would apply on the first day applies to sales or supplies of alcohol which take place before the expiry of the period of 14 days beginning on the second day.

MANDATORY CONDITIONS RELATING TO THE EXHIBITION OF FILMS

Licensing Act, 2003 - Section 20

A premises licence that authorises the exhibition of films is granted subject to the following conditions, requiring the admission of children to the exhibition of any film to be restricted:

- 1. Where the film classification body is specified in the licence, unless subsection 3(b) applies, admission of children must be restricted in accordance with any recommendation by that body.
- 2. Where-
 - (a) the film classification body is not specified in the licence, or
 - (b) the Licensing Authority has notified the holder of the licence that subsection (3)(b)



Licensing Act 2003
Premises Licence

PL0425

ANNEXES continued ...

applies to the film in question,
admission of children must be restricted in accordance with any recommendation by the
Licensing Authority.

'children' means person aged under 18, and
'film classification body' means the person or persons designated as the authority under section
4 of the Video Recordings Act, 1984 (c.39) (authority to determine suitability of video works for
classification)

MANDATORY CONDITIONS RELATING TO THE USE OF DOOR SUPERVISORS

Licensing Act, 2003 - Section 21

(1)Where a premises licence includes a condition that at specified times one or more individuals
must be at the premises to carry out a security activity, the licence must include a condition that each
such individual must

(a) be authorised to carry out that activity by a licence granted under the Private Security Industry Act
2001; or

(b) be entitled to carry out that activity by virtue of section 4 of that Act

(2)But nothing in subsection (1) requires such a condition to be imposed-

(a)in respect of premises within paragraph 8(3)(a) of Schedule 2 to the Private Security Industry Act
2001 (c. 12) (premises with premises licences authorising plays or films), or

(b)in respect of premises in relation to-

(i)any occasion mentioned in paragraph 8(3)(b) or (c) of that Schedule (premises being used
exclusively by club with club premises certificate, under a temporary event notice authorising plays or
films or under a gaming licence), or

(ii)any occasion within paragraph 8(3)(d) of that Schedule (occasions prescribed by regulations under
that Act).

(3)For the purposes of this section-

(a)"security activity" means an activity to which paragraph 2(1)(a) of that Schedule applies, and

(b)paragraph 8(5) of that Schedule (interpretation of references to an occasion) applies as it applies
in relation to paragraph 8 of that Schedule.



Licensing Act 2003
Premises Licence

PL0425

ANNEXES continued ...

Conditions Consistent with the Operating Schedule

Prevention of Crime and Disorder

A text/pager/radio will be used to keep in contact with the premises providing licensable activities on the park.

From 18.00 two door supervisors shall be on duty. A register of names will be kept along with times they were on duty. The door staff shall carry their proof of registration with the SIA and wear their name badges at all times.

The licensee shall, within the licensed premises, provide and maintain efficient video recording equipment (CCTV) and recordings shall be kept for a period of one month.

No person who is the subject of a court banning order shall be allowed in the premises provided the details of such person have been provided by the police.

No customer shall be allowed to bring alcohol in open or sealed bottles on the premises.

Tables shall be cleared of all empty bottles and glasses on a regular basis.

Promotion of Public Safety

Consideration will be given to fixing a capacity limit after consultation with the fire service, if deemed necessary.

There shall be sufficient adequately trained staff to ensure safe evacuation from the premises in the event of an emergency.

All fire escape routes shall be kept unobstructed, and be clearly identifiable.

All fire exit doors shall be capable of opening without use of any key, card, code or similar means.

Hangings, curtains and temporary decorations shall be maintained in a flame retardant condition and shall not obstruct fire exits, fire safety signs or fire fighting equipment.

All upholstered seating shall comply with current fire safety regulations.

Fire evacuation tests shall be carried out every 6 months and a record kept, all fire fighting equipment and emergency lighting shall be maintained in good working order.



Licensing Act 2003
Premises Licence

PL0425

ANNEXES continued ...

At least one first aider shall be on duty.

There shall be no demonstration of hypnotism without prior approval of the Licensing Authority.

An adequate supply of free drinking water shall be provided for customers.

Risk assessments will regularly take place at the premises and an action plan will be prepared and implemented.

Fire doors will be self closing and shall not be held open other than by devices approved by the Fire Service or Health and Safety department.

Edges to steps and stairways shall be maintained so as to be conspicuous.

Prevention of Public Nuisance

Doors and windows will be kept closed where necessary.

The playing of recorded music in any outside area shall not continue after 23.00

Protection of Children from Harm

The premises shall operate a photographic proof of age scheme.

All staff shall be trained to ensure that no person under the age of 18 is sold intoxicating liquor.

No performance involving nudity or striptease shall take place at the premises.

The premises shall observe the Portman Group's code of practice on the naming, packaging and promotion of alcoholic drinks.

Where performances are presented especially for unaccompanied children there shall be at least one attendant for every 50 children or part thereof.

All staff working in the Entertainment venues or security staff must provide Parkdean Caravan Parks Limited with a Criminal Record Bureau Check.



Licensing Act 2003

Premises Licence

PL0425

ANNEXES continued ...





Licensing Act 2003

Premises Licence Summary

PL0425

Premises Details

POSTAL ADDRESS OF PREMISES, OR IF NONE, ORDNANCE SURVEY MAP REFERENCE OR DESCRIPTION

Cherry Tree Holiday Park

Mill Road, Burgh Castle, Norfolk, NR31 9QR.

Telephone 780024

WHERE THE LICENCE IS TIME LIMITED THE DATES

Not applicable

LICENSABLE ACTIVITIES AUTHORISED BY THE LICENCE

- a performance of a play
- an exhibition of a film
- a performance of live music
- any playing of recorded music
- a performance of dance
- the supply of alcohol

THE TIMES THE LICENCE AUTHORISES THE CARRYING OUT OF LICENSABLE ACTIVITIES

Activity (and Area if applicable)	Description	Time From	Time To
A. Performance of a play (Indoors)	Sunday	10:00am	2:00am
	Monday	10:00am	2:00am
	Tuesday	10:00am	2:00am
	Wednesday	10:00am	2:00am
	Thursday	10:00am	2:00am
	Friday	10:00am	2:00am
	Saturday	10:00am	2:00am
	Non Standard Timings: Morning of BST	10:00am	3:00am
	Non Standard Timings: New Years Eve	10:00am	10:00am
B. Exhibition of films (Indoors)	Sunday	10:00am	2:00am
	Monday	10:00am	2:00am
	Tuesday	10:00am	2:00am
	Wednesday	10:00am	2:00am
	Thursday	10:00am	2:00am
	Friday	10:00am	2:00am
	Saturday	10:00am	2:00am
	Non Standard Timings: Morning of BST	10:00am	3:00am
	Non Standard Timings: New Years Eve	10:00am	10:00am
E. Performance of live music (Indoors)	Sunday	10:00am	2:00am
	Monday	10:00am	2:00am
	Tuesday	10:00am	2:00am





Licensing Act 2003

Premises Licence Summary

PL0425

THE TIMES THE LICENCE AUTHORISES THE CARRYING OUT OF LICENSABLE ACTIVITIES continued...

Activity (and Area if applicable)	Description	Time From	Time To
E. Performance of live music (Indoors)	continued ...		
	Wednesday	10:00am	2:00am
	Thursday	10:00am	2:00am
	Friday	10:00am	2:00am
	Saturday	10:00am	2:00am
	Non Standard Timings: Morning of BST	10:00am	3:00am
	Non Standard Timings: New Years Eve	10:00am	10:00am
F. Playing of recorded music (Indoors)	Sunday	10:00am	2:00am
	Monday	10:00am	2:00am
	Tuesday	10:00am	2:00am
	Wednesday	10:00am	2:00am
	Thursday	10:00am	2:00am
	Friday	10:00am	2:00am
	Saturday	10:00am	2:00am
	Non Standard Timings: Morning of BST	10:00am	3:00am
	Non Standard Timings: New Years Eve	10:00am	10:00am
G. Performance of dance (Indoors)	Sunday	10:00am	2:00am
	Monday	10:00am	2:00am
	Tuesday	10:00am	2:00am
	Wednesday	10:00am	2:00am
	Thursday	10:00am	2:00am
	Friday	10:00am	2:00am
	Saturday	10:00am	2:00am
	Non Standard Timings: Morning of BST	10:00am	3:00am
	Non Standard Timings: New Years Eve	10:00am	10:00am
J. Supply of alcohol for consumption ON and OFF the premises	Sunday	10:00am	2:00am
	Monday	10:00am	2:00am
	Tuesday	10:00am	2:00am
	Wednesday	10:00am	2:00am
	Thursday	10:00am	2:00am
	Friday	10:00am	2:00am
	Saturday	10:00am	2:00am
	Non Standard Timings: Morning of BST	10:00am	3:00am
	Non Standard Timings: New Years Eve	10:00am	10:00am

THE OPENING HOURS OF THE PREMISES

Description	Time From	Time To
Sunday	8:00am	2:30am



Licensing Act 2003

Premises Licence Summary

PL0425

THE OPENING HOURS OF THE PREMISES continued ...

Description	Time From	Time To
Monday	8:00am	2:30am
Tuesday	8:00am	2:30am
Wednesday	8:00am	2:30am
Thursday	8:00am	2:30am
Friday	8:00am	2:30am
Saturday	8:00am	2:30am
Non Standard Timings: Morning of BST	8:00am	3:30am
New Years Eve	8:00am	8:00am

WHERE THE LICENCE AUTHORISES SUPPLIES OF ALCOHOL WHETHER THESE ARE ON AND / OR OFF SUPPLIES

- J. Supply of alcohol for consumption ON and OFF the premises

NAME (REGISTERED) ADDRESS OF HOLDER OF PREMISES LICENCE

Parkdean Caravan Parks Limited 2nd Floor, 1, Gosforth Park Way, Gosforth Business Park, Newcastle upon Tyne, NE12 8ET.

REGISTERED NUMBER OF HOLDER, FOR EXAMPLE COMPANY NUMBER, CHARITY NUMBER (WHERE APPLICABLE)

Parkdean Caravan Parks Limited

5231267

NAME OF DESIGNATED PREMISES SUPERVISOR WHERE THE PREMISES LICENCE AUTHORISES THE SUPPLY OF ALCOHOL

Thomas Bernard BARRON

STATE WHETHER ACCESS TO THE PREMISES BY CHILDREN IS RESTRICTED OR PROHIBITED



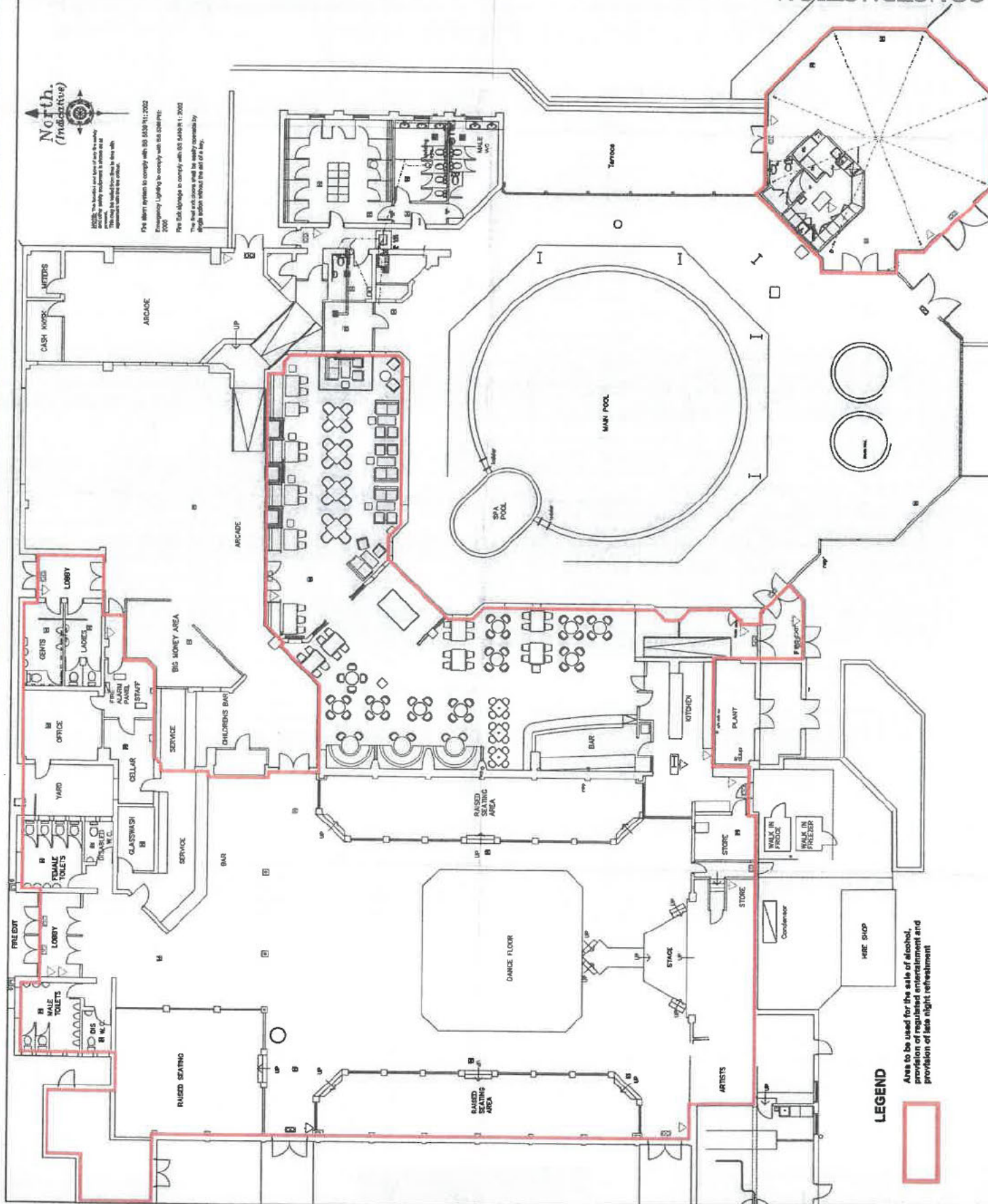

Elaine M. Hignett

From: Kelly Hutchinson - [REDACTED]
Sent: 12 February 2024 20:10
To: licensing
Subject: Notice of application - objection.

Categories: Green category

Good evening,

I am writing to raise concerns about the proposed variation of premises licence at Parkdean Caravan Park (Cherry Tree, Mill Rd, Burgh Castle).

Living in extremely close proximity, the area of concern relates to the extension of potential noise nuisance this will cause. The power of the amplification of music etc is already clearly audible in a wide area outside of the site. If the music etc is allowed to extend for more than 11 hours a day this will create an unacceptable nuisance factor for us neighbours that work full time. 7 days a week and 2am is simply disrespectful.

How will lighting levels of outdoors events affect us too? Extending usage-will the extended opening hours lead to unacceptable levels of light pollution?

Before any varied licence is granted tests should be completed to ascertain if noise levels can be kept at an acceptable level.

We strongly object to this application on the grounds of public nuisance. Extending late night music 7 days a week will be a public nuisance and breach our entitlement of quiet in our homes - a legal right. We need to try to preserve some form of peace and quiet in this rural environment.

kind regards

Mr & Mrs Hutchinson
Lawn Cottage
Mill Road
Burgh Castle
NR31 9QS

Sent from my iPad

Elaine M. Hignett

From: [REDACTED]
Sent: 05 March 2024 21:14
To: Elaine M. Hignett
Subject: Cherry Tree Holiday Park

Categories: To Do

Dear Elaine

I just wanted to log an objection to all the licensing extensions and amendments to the premises license on the Cherry Tree holiday park, Mill Road, Burgh Castle. I live next door to the Cherry Tree very close to the entertainment area and feel that the extension until 2am-2.30am is unacceptable particularly Section H where they are asking for both outdoor and indoor entertainment not covered in other sections to be granted a license until 2.30am. This holiday park is situated in our village, and I feel that the villagers are the last people considered by local businesses' when they want to make changes.

This extension would encourage extra noise, increased traffic, especially late at night, and all making our village a more polluted place. Along with extra traffic, anti-social behavior is something that we don't want to see in this quiet village, historically longer drinking hours encourage this. I feel that Cherry Tree holiday park is a family park and surely these hours and types of entertainment are intended to encourage adult only parties with a club 18-30 attitude.

There is also concern that an extension to the license may allow them to hold events out of the main holiday season, which could result in a large amount traffic and also may extend the season. If these events were to be staged, they could attract a large number of people who are not even residents at the park. With section H they could hold a festival or something similar and you would have given them license to.

I look forward to your confirmation of receipt of my objection

Kind Regards

Mrs Wendy Griffiths
Four Acres
Mill Road
Burgh Castle
Great Yarmouth
NR31 9QS

Sent via BT Email App

Elaine M. Hignett

From: Glen Miller <[REDACTED]>
Sent: 03 March 2024 15:47
To: licensing
Subject: Cherry Tree Holiday Park, Burgh Castle
Categories: Green category

To whom it may concern,

I believe Cherry Tree Holiday Park have applied for Premises Licence variation with GYBC.

My Wife, Daughter, Granddaughter and I, who live at Strawlands, Mill Road, Burgh Castle, NR31 9QW (5 properties away), would like to object to the part of the application for outdoor music (live and recorded) until 11pm.

There was outdoor and live music played last year, however, this was at a high decibel level which kept us awake on several occasions.

Is there a need for this to be outside until 11pm when they would move everyone indoors to continue to 2am each day (if the application was accepted).

Best regards

Glen Miller - [REDACTED]

Elaine M. Hignett

From: Kate Palmer <[REDACTED]>
Sent: 01 March 2024 08:36
To: Elaine M. Hignett
Subject: Cherry Tree Holiday Park, Mill Road, Burgh Castle, Great Yarmouth
Categories: To Do

Good Morning Elaine,

Please find below comments from Burgh Castle Parish Council concerning the Cherry Tree Holiday Park proposed variation to license.

Kind regards, Kate

Cherry Tree Holiday Park, Mill Road, Burgh Castle - Variation to Premises License

Burgh Castle Parish Council strongly objects to the premises licence being extended.

Any intensification of activities at Cherry Tree Holiday Park that will increase noise and light pollution, coupled with possible extra late night traffic movement, and reduction of security that may allow unrestricted movement into the park's activities should not be allowed.

There is enough noise pollution in the summer from this location, outdoor music until 11pm would be a nuisance to neighbouring residents and depending on the prevailing wind could be extremely noisy, it also may encourage anti-social behaviour. A 2.00am indoor license would be much the same, encouraging people to drink until much later in the evening/early hours of the morning, which again could lead to anti-social behaviour. Some of the other holiday parks owned by the company may already have extended licenses such as Vauxhall Holiday Park, however they are located in different parts of the borough and are not set in a village like Burgh Castle where the Cherry Tree Holiday Park is located.

There is also concern an extension to the licence may allow them to hold events out of the main holiday season, which could result in a large amount of additional transient weekend traffic which may extend the season. If these events were to be staged they could attract a large number of people who have no affinity to the area. All late night events should be specifically restricted to 'residents' of Cherry Tree site and exclude use by residents from any other Parkdene sites to prevent late night travel and disturbance.

Elaine M. Hignett

From: Lee Barnard <[REDACTED]>
Sent: 07 March 2024 10:47
To: licensing
Subject: Re: Cherry Tree Holiday Park, Mill Road, Burgh Castle, NR31 9QR - variation to premises licence
Categories: Green category

Dear Elaine,

Thank you for taking the time to respond to me having followed up my enquiry with Cherry Tree's agent.

I am comforted by the fact they have already been holding outdoor events on a temporary basis, given these events have not caused us any concern.

A couple of thoughts, given their request would enable them to say, play recorded music outside all year round late into the evening, there is the potential for this to become a nuisance, which as I see it, is dependent upon the following two factors: volume and time. On the basis their previous temporary requests for outdoor events have been during the periods listed below, is an all year-round licence variation necessary? The Council could provide the variation in accordance with what the park actually requires (see your email dated 14th Feb and below), whilst reserving their position via TENs outside of these key trading periods. Could I also suggest a maximum volume is considered?

To summarise, I would like to make a formal representation/suggestion as follows:

- Fundamentally supportive of Cherry Tree's request to vary the licence agreement subject to;

Can the variation match the periods they currently enjoy but via many TENs: peak (mid June - mid September), bank holiday weekends, and school holidays (throughout the year)?

Can a maximum volume be determined to mitigate any potential for nuisance as a result of excessive airborne sound transmission?

The above would appear to give Cherry Tree what it requires whilst also protecting immediate residents from any unreasonable nuisance. Cherry Tree secures a variation removing the requirement for TENs entirely during their peak operational periods, only having to apply for TENs in the unlikely event they wish to hold an outdoor activity outside of these. A volume cap would ensure they get what they need, whilst providing the licencing team with a simple mechanism for proving a nuisance should one be claimed.

I suspect we will continue to live in harmony but a less broad variation would ensure it.

Many thanks again for your assistance.

With kind regards,

Lee Barnard
Meadow View
Lord's Lane

Burgh Castle
NR31 9EP

From: licensing <licensing@great-yarmouth.gov.uk>

Sent: 14 February 2024 4:53 PM

To: [REDACTED]

Subject: FW: Cherry Tree Holiday Park, Mill Road, Burgh Castle, NR31 9QR - variation to premises licence

Dear Mr Barnard

Further to my earlier email, I have received a response from the holiday park's agent containing further information on the proposed variation, as detailed below:

'In a nutshell there is not plan to change the type and frequency of outdoor entertainment compared to previous years. What this application does (if granted) is allow my client to run their entertainment under the terms of the Premises Licence and not have to issue TENS each time the proposed entertainment falls outside the scope of the Premises Licence in its current form.

The park currently hold outdoor entertainment during the following periods:

- *peak (mid June - mid September)*
- *bank holiday weekends, and*
- *school holidays (throughout the year)*

Usually the entertainment consists of outdoor movie nights 2 or 3 times per week, occasional family fun sports days and live acts 1 or 2 times per week. To date there have been no complaints about noise nuisance communicated to my client so they assume they operate these events in such that local residents are not disturbed.'

I hope this gives the information that you require but feel free to contact me if you have any other queries.

Kind regards

Elaine

Elaine M. Hignett

Licensing Officer

Licensing and Elections

Environmental Services

Great Yarmouth Borough Council

Email: Elaine.Hignett@great-yarmouth.gov.uk

www.great-yarmouth.gov.uk

Telephone: 01493846530



Winners at the LGC Awards 2023 for 'Economic Support'
Highly Commended at the MJ Awards for 'Community Heroes'

To read our email disclaimer visit here: www.great-yarmouth.gov.uk/email-disclaimer





Cherry Tree Holiday Park
Mill Lane
Burgh Castle
Great Yarmouth